

Specifications

Model	EC787U/32WE, ED787U/32WE
Supply voltage	230-240 V a.c. 50 Hz
GPO current rating	32A

EC = common plate version
 ED = dedicated plate version

This product complies with safety standard AS/NZS 3112

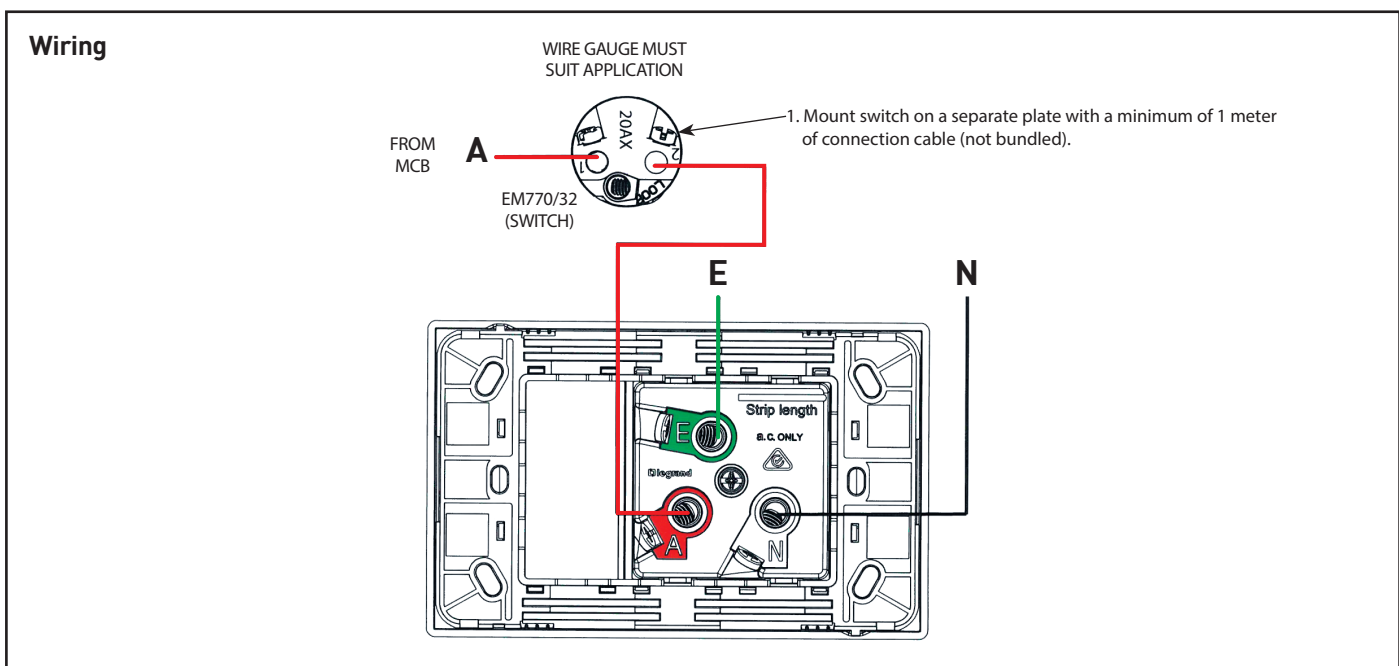

- ### Disclaimers
- This product must be installed by a licensed electrician. This product must be installed and used as per these instructions. For indoor use only.
 - This product has been designed to operate in ambient temperatures 5°C to 40°C.
 - The material in this product may vary in colour from batch to batch. Colour matching from one batch to another cannot be guaranteed.
 - This product has been designed to operate on a nominal supply voltage of 230 - 240V a.c. 50 Hz.
 - This product utilises intellectual property in the form of registered designs, trademarks, and/or patents. Such intellectual property remains the property of Legrand in all cases.
 - This product should only be cleaned with a damp cloth. Cleaning agents should not be used.
 - Legrand reserves the right to modify the specification of this product at any time.

Warranty

Legrand will honour all statutory guarantees that you as a consumer are entitled to rely upon under the Australian and New Zealand Consumer Laws against a manufacturer including a guarantee that any products. Legrand has manufactured or imported are of acceptable quality.

To make a claim under any statutory guarantee (or other warranty) you should first contact the supplier, contractor or retailer from whom you purchased the products.

Customer Service

For all Customer Service and Technical Support enquires please call Monday to Friday during business hours.

Legrand Australia
 1300 369 777
www.legrand.com.au

Legrand New Zealand
 0800 476 009
www.legrand.co.nz

ABN: 31 000 102 661