

Data Sheet

Como Mechanism, 1 Gang 2-Way Switch with LED, 10A



CAT NO. **CMM910NWE, CMM910RNWE, CMM910LNWE**



CMM910NWE



CMM910RNWE



CMM910LNWE

Cat No	CMM910NWE	CMM910RNWE	CMM910LNWE
Description	Como mechanism 1 gang 2-way switch single pole double throw with red LED, 10A	Como mechanism 1 gang 2-way switch single pole double throw, right hand side with red LED, 10A	Como mechanism 1 gang 2-way switch single pole double throw, left hand side with red LED, 10A
Supply voltage	230 - 240Va.c.		
Current rating	10AX		
Colour	White (WE)		
Mechanism size	45 W x 45 H x 35 D mm		
Compliance	AS/NZS 3133, AS 1428.1		

Como Mechanism, 1 Gang 2-Way Switch with LED, 10A



CAT NO. **CMM910NWE, CMM910RNWE, CMM910LNWE**



CMM910NWE



CMM910RNWE



CMM910LNWE

■ Red LED indicator (externally wired)

Single product			
Cat No	Dimensions	Weight	Barcode
CMM910NWE	110 W x 170 H x 35 D mm	0.03kg	9321001438526
CMM910RNWE	110 W x 170 H x 35 D mm	0.03kg	9321001438809
CMM910LNWE	110 W x 170 H x 35 D mm	0.03kg	9321001438793

Inner box (Qty 10)			
Cat No	Dimensions	Weight	Barcode
CMM910NWE	126 W x 162 H x 83 D mm	0.39kg	9321001439509
CMM910RNWE	126 W x 162 H x 83 D mm	0.39kg	9321001439783
CMM910LNWE	126 W x 162 H x 83 D mm	0.39kg	9321001439776

Outer box (Qty 120)			
Cat No	Dimensions	Weight	Barcode
CMM910NWE	330 W x 250 H x 250 D mm	5.07kg	9321001440482
CMM910RNWE	330 W x 250 H x 250 D mm	5.07kg	9321001440765
CMM910LNWE	330 W x 250 H x 250 D mm	5.07kg	9321001440758

Device assembly

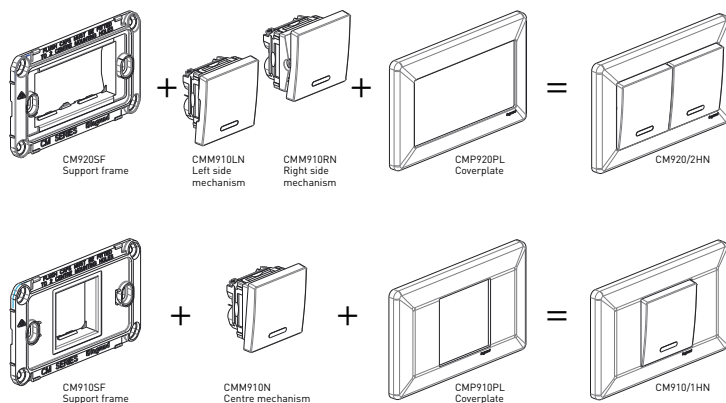

HPM Legrand - AUS
1300 369 777
www.legrand.com.au
ABN 31 000 102 661

HPM Legrand - NZ
0800 476 009
www.legrand.co.nz

Refer to your group buying office, HPM Legrand Sales Representative or HPM Legrand Sales Office for pricing.