

Operation

- This part may be fitted with EM770 switch for illuminating switches
- Up to 6 mechs can be used on a switch plate
- Voltage: 230-240V a.c.
- Light source: LED
- Power: 0.25W

Installation

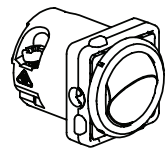

1. Standard switch

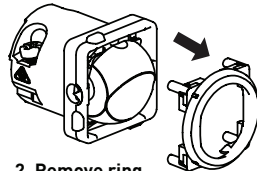

2. Remove ring

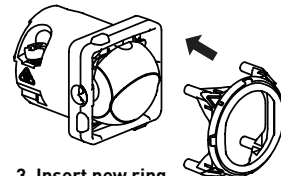

3. Insert new ring



4. Screws must be fully screwed in

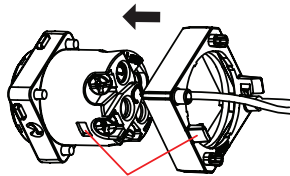

5. Align the slot and push

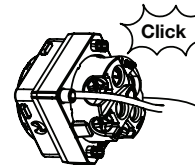

6. Engage in slot

Wiring

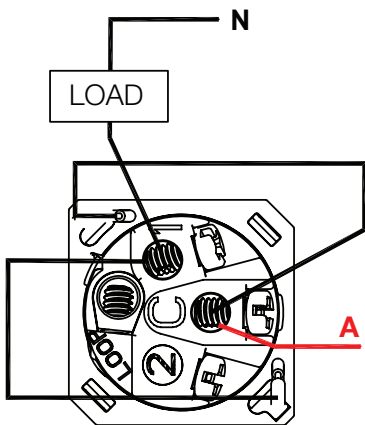

LED on when "OFF"

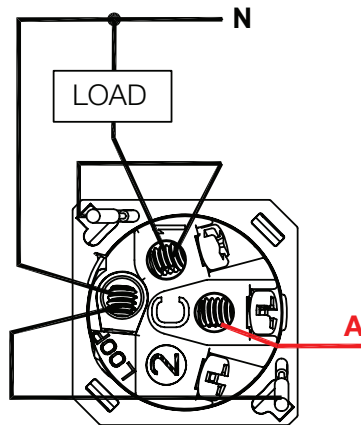

LED on when "ON"

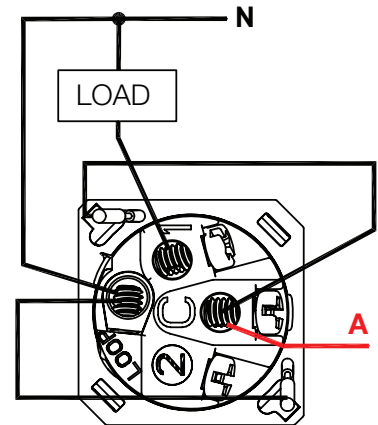

LED on "ALWAYS"

Warranty

HPM Legrand will honour all statutory guarantees that you as a consumer are entitled to rely upon under the Australian Consumer Law against a manufacturer including a guarantee that (any products HPM Legrand has manufactured or imported/the products which are described in this Instruction Manual) EM770LED products are of acceptable quality.

To make a claim under any statutory guarantee (or other warranty) you should first contact the supplier, contractor or retailer from whom you purchased the products.

Customer Service

For all Customer Service and Technical Support please call Monday to Friday during business hours.

HPM Legrand Australia
1300 369 777
www.hpmlegrand.com.au

HPM Legrand New Zealand
0800 476 009
www.hpmlegrand.co.nz

ABN: 31 000 102 661