

ON

1. Press OK to enter the language menu.
2. Press right arrow to select English.
3. Press left arrow to confirm English.
4. Press OK to enter the sensor parameters menu (repeated x2).

OFF

≈ 2 s.

AUTO OFF

≈ 5 min.

4 m

+/- 15°

ERGONOMIE / ERGONOMICS / ERGONOMÍA

• Exemple : réglage temporisation

• Example: time delay setting

• Ejemplo: ajuste de temporización

1. Press OK to enter the menu.
2. Press right arrow to go to 'Settings'.
3. Press left arrow to go to 'Sensor parameters'.
4. Press right arrow to go to 'Time delay'.
5. Press right arrow to enter the time delay value.
6. Press right arrow to confirm the value.

- Config outils
- Herramientas config
- Paramètres capteur
- Parámetros captador
- Temporisation
- Temporización

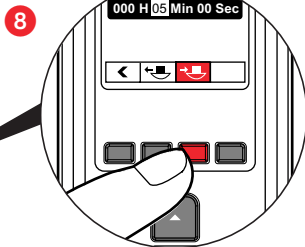
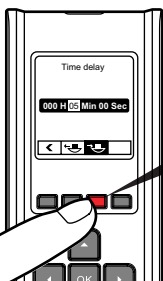
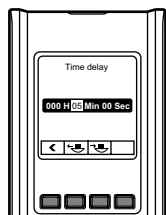

- Retour
- Back
- Volver

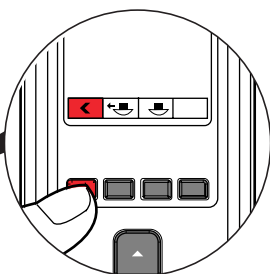
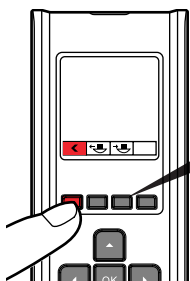

IMPORTER / IMPORT / IMPORTAR

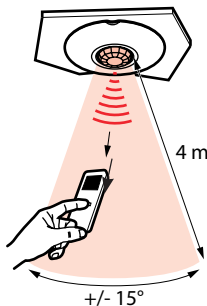
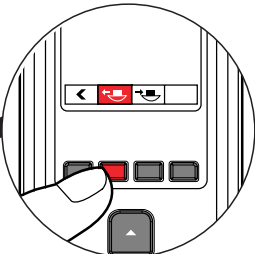
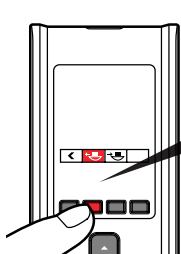

- Après l'import, seuls les paramètres propres au produit apparaissent dans l'outil de configuration.
- After importing, only product-specific parameters appear in the configuration tool.
- Tras la importación, solamente aparecen en la herramienta de configuración los parámetros propios del producto.

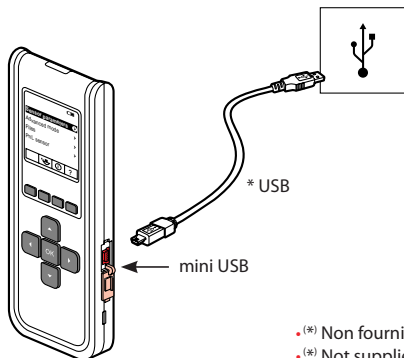

* USB

← mini USB

- (*) Non fourni
- (*) Not supplied
- (*) No suministrado

 www.legrandoc.com

- Logiciel de mise à jour disponible sur www.legrandoc.com
- Software update available at www.legrandoc.com
- Actualización del software disponible en el sitio www.legrandoc.com