

10	XL770VCKT11	3 x 20A switches in top pocket, 10A independent switch below
10	XL770VCKT12	3 x 20A switches in top pocket, 10A independent switch & neon below
10	XL770VCKT13	3 x 20A switches & neon in base pocket
10	XL770VCKT14	4 x 20A switches in base pocket
10	XL770VCKT15	3 x 20A switches & neon in top pocket
10	XL770VCKT16	4 x 20A switches in top pocket



XL770KM1

Pack	Cat No.	KeyCard switches
Plate size: 73 x 117mm. Mounting centres: 84mm. Available in white only. Activation by insertion of a room access card, (not supplied). Base pocket style KeyTags are available with plastic cover plates only.		
10	XL770KM1	2 x 20A switches & neons in base pocket
10	XL770KM2	2 x 20A switches & neons in base pocket, 10A independent switch above
10	XL770KM3	2 x 20A switches & neons in base pocket, 10A independent switch & neon above
10	XL770KM7	2 x 20A switches & neons in top pocket
10	XL770KM8	2 x 20A switches & neons in top pocket, 10A independent switch below
10	XL770KM9	2 x 20A switches & neons in top pocket, 10A independent switch & neon below



XL770KT1

Pack	Cat No.	KeyTag switches
Plate size: 73 x 117mm. Mounting centres: 84mm. Supplied with Cat. No. 770/20KTM switches inside pockets, Cat. No. 707M neons (opal in pocket, red outside), Cat. No. 770T3 blank tag. The KeyTag mechanisms supplied are interchangeable with other mechs. Detailed below. Base pocket style KeyTags are available with plastic cover plates only.		
10	XL770KT1	2 x 20A switches & neon in base pocket
10	XL770KT2	2 x 20A switches & neon in base pocket, 10A independent switch above
10	XL770KT3	2 x 20A switches & neon in base pocket, 10A independent switch & neon above
10	XL770KT4	3 x 20A switches in base pocket
10	XL770KT5	3 x 20A switches in base pocket, 10A independent switch above
10	XL770KT6	3 x 20A switches in base pocket, 10A independent switch & neon above
10	XL770KT7	2 x 20A switches & neon in top pocket
10	XL770KT8	2 x 20A switches & neon in top pocket, 10A independent switch below
10	XL770KT9	2 x 20A switches & neon in top pocket, 10A independent switch & neon below
10	XL770KT10	3 x 20A switches in top pocket
10	XL770KT11	3 x 20A switches in top pocket, 10A independent switch below
10	XL770KT12	3 x 20A switches in top pocket, 10A independent switch & neon below
10	XL770KT13	3 x 20A switches & neon in base pocket
10	XL770KT14	4 x 20A switches in base pocket
10	XL770KT15	3 x 20A switches & neon in top pocket
10	XL770KT16	4 x 20A switches in top pocket
10	770T3	<b>KeyTags</b> Keytag, 100mm long, with removable insert

# Colour Options for the Excel Range

# Section 2

## How to order

Excel Range is available in various colours and metallic finishes. When ordering add ordering code/s to the end of Cat. No.

e.g. XLP777BU, XL777BLMS

Please note: Not all colours and/or metallic finishes are available on all products. Please check when ordering. Minimum quantities may apply.

<b>XLP</b> High Gloss Cover Plate	Gloss Finish Colours Available					
	White <b>WE</b>	Cream <b>CR</b>	Beige <b>BE</b>	Mist Grey <b>MG</b>	Brown <b>BR</b>	Black <b>BL</b>

<b>XL</b> Regular Cover Plate	Matt Finish Colours Available								
	White <b>WE</b>	Cream <b>CR</b>	Beige <b>BE</b>	Mist Grey <b>MG</b>	Brown <b>BR</b>	Black <b>BL</b>	Red <b>RED</b>	Blue <b>BU</b>	Green <b>GR</b>

	Metallic Finishes Available					
	Polished Silver <b>PS</b>	Matt Silver <b>MS</b>	Stainless Steel* <b>SS</b>	Stone Metal <b>SM</b>	Brushed Brass* <b>BB</b>	Polished Brass <b>PB</b>

\*Solid Metal

## Single powerpoints

Cat No.

- XL787 Plate size: 117 x 73mm.  
Mounting centres: 84mm
- XL787/20 Plate size: 117 x 73mm.  
Mounting centres: 84mm
- XL787/25 Plate size: 117 x 73mm.  
Mounting centres: 84mm
- XL787/32 Plate size: 117 x 73mm.  
Mounting centres: 84mm

XL787

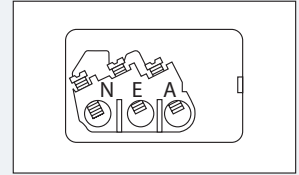
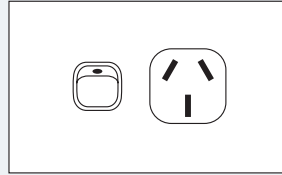

XL787/20

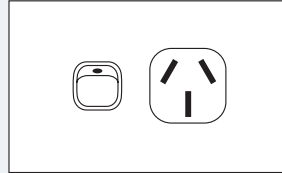

XL787/25

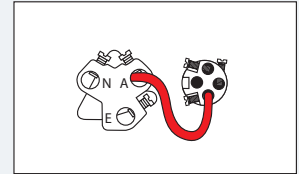
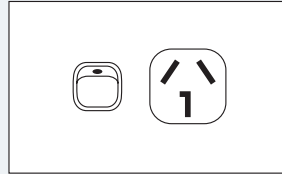

XL787/32

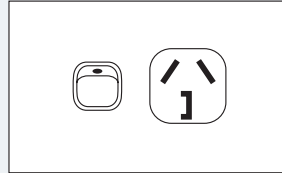

## Single powerpoints with extra switch

- XL787X Plate size: 117 x 73mm.  
Mounting centres: 84mm

XL787X

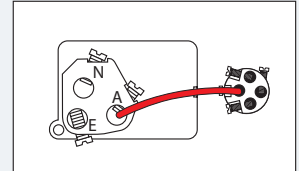
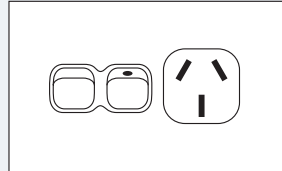

## Single powerpoints with 2 extra switches

- XL787/2X Plate size: 117 x 73mm.  
Mounting centres: 84mm

XL787/2X

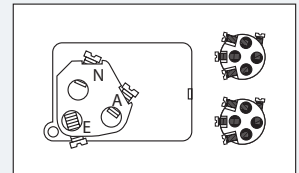
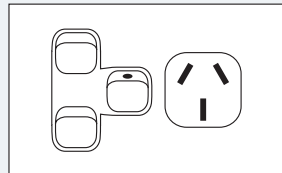

## Vertical single powerpoint

- XLV787 Plate size: 73 x 117mm.  
Mounting centres: 84mm

XLV787

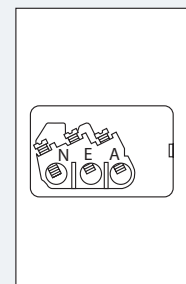
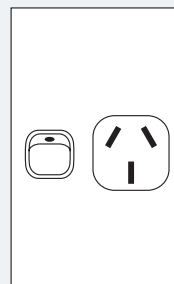

## Vertical single powerpoints with extra switch

Cat No.

XLV787X

Plate size: 70 x 114mm.  
Mounting centres: 84mm

XLV787X

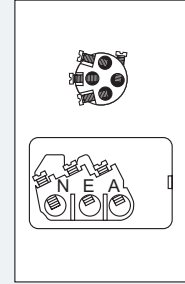
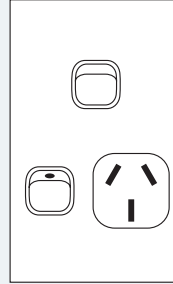

## Vertical single powerpoints with 2 extra switches

XLV787/2X

Plate size: 73 x 117mm.  
Mounting centres: 84mm

XLV787/2X

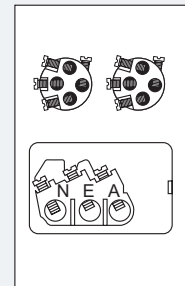
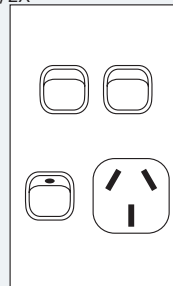

## Double powerpoints

XL777

Plate size: 117 x 73mm.  
Mounting centres: 84mm

XL777

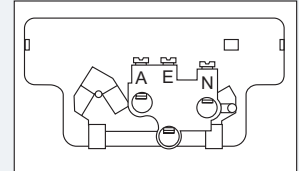
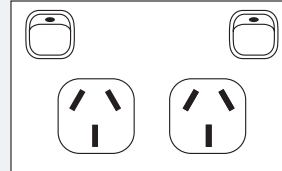

## Double powerpoints with extra switch

XL777X

Plate size: 117 x 73mm.  
Mounting centres: 84mm

XL777X

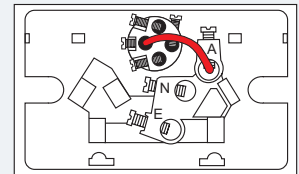
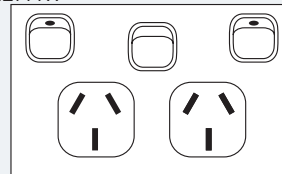

## Vertical double powerpoints

XLV777

Plate size: 73 x 117mm.  
Mounting centres: 84mm

XLV777

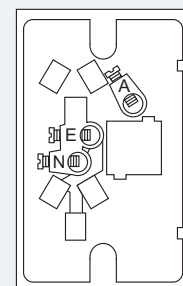
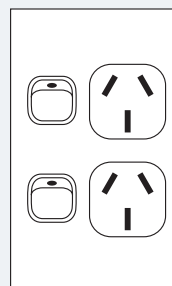

### Vertical double powerpoints with extra switch

Cat No.

XLV777X

Plate size: 73 x 117mm.  
Mounting centres: 84mm

XLV777X

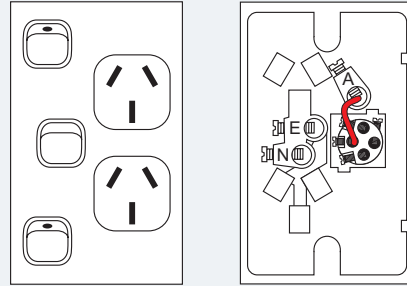

### Electresafe powerpoints, 10mA tripping

XL777EL10

Plate size: 117 x 73mm.  
Mounting centres: 84mm

XL777EL10

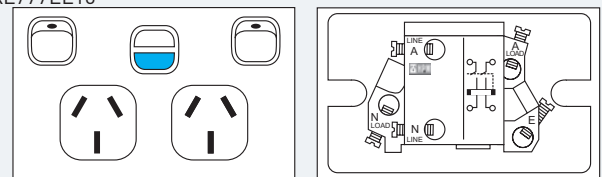

### Electresafe powerpoints, 30mA tripping

XL777EL30

Plate size: 117 x 73mm.  
Mounting centres: 84mm

XL777EL30

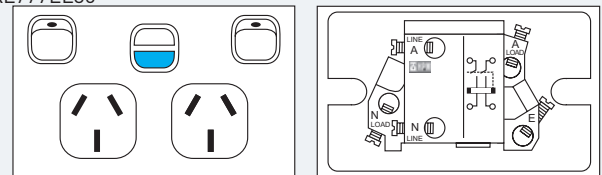

### Power brown out monitor

XL787B

Plate size: 117 x 73mm.  
Mounting centres: 84mm

XL787B

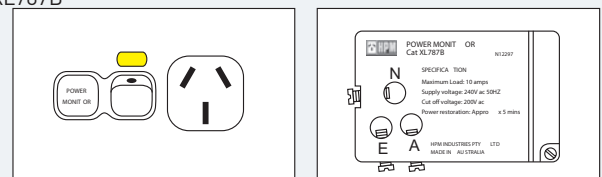

### Surge protecting double powerpoints

XL777PA

Plate size: 117 x 73mm.  
Mounting centres: 84mm

XL777PA

