

Control and signalling transformers, terminals, crimping tools and marking systems.

Transformers, power supplies

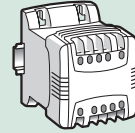

P. 150
Control and signalling transformers (AC)

Connection



P. 158
Viking 3 terminal blocks selection chart

Cabling components, marking system

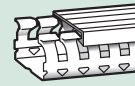

P. 176
Transcab™ and LINA slotted duct

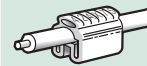

P. 182
Memocab marking system for wiring



Viking 3 terminal blocks (P. 162)



Starfix ferrules and crimping tools (P. 178)

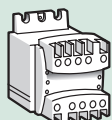

P. 150
Equipment
transformers
(AC)



P. 152
Transformers
sizing and
protection

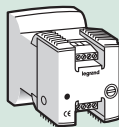

P. 155
Filtered rectified
power supplies (DC)

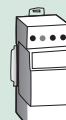

P. 156
Bell
transformer



P. 162
Viking 3
terminal blocks
with screw
connection

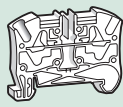

P. 164
Viking 3
terminal blocks
with spring
connection

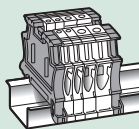

P. 166
Viking 3
accessories



P. 168
Viking 3
technical
characteristics



P. 172
Viking 3
power terminal
blocks

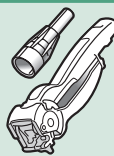

P. 178
Starfix
ferrules and
crimping
tools

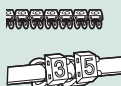

P. 180
CAB 3 marking
system for wiring
and terminal
blocks



P. 184
Duplix™ marking
system for cables



**Starfix
assorted kit
(P. 178)**

Control and signalling transformers

Single-phase - screw connection - AC

Equipment transformers

Single-phase - AC



442 33



442 68

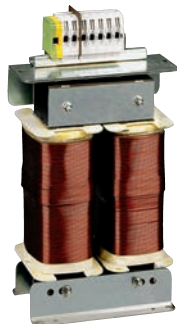

442 71

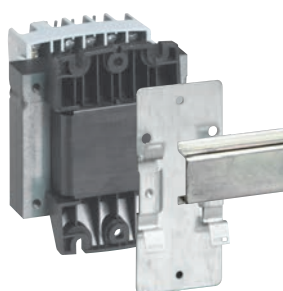

428 40 +
428 99



428 41
supplied with connection
strip



connection strip
supplied up to 220 VA

Technical characteristics (p. 152)

IP 2X or XXB up to 400 VA - IP XXA over 400 VA - IK 04
Conform to IEC EN 61558-2-2 and 2-4 or 2-6, UL506 and CSA C22-2-No 66
UL USA and Canada agreements
Products suitable for building equipment conforming to standards EN
61131-2, EN 60204-1 and EN 60439-1
Active parts protected by cover up to 1000 VA
Interference filtering
Direct fixing possibility on symmetrical rail up to 250 VA
Supplied with connection strip 0 V secondary / earth up to 1000 VA

IP 2X or XXB up to 220 VA - IK 04
Clip on fixing possibility up to 160 VA with accessories
Cat. No. 044 16 or 428 99
Transformers with 2 secondary voltage supplied with coupling strip
and with isolated strip for 0 V connection secondary / earth connection
Conform to IEC EN 61558-2-6 for 12 V and 24 V
Products suitable for building equipment conforming to standards EN
61131-2, EN 60204-1 and EN 60439-1

Pack	Cat. No.	Control and safety		
		24-48 V		
		230-400 V \pm 15 V (primary) / 24-48 V (secondary)		
		Supplied with 2 coupling strips		
		Power in VA	Instantaneous	
		according to IEC and CSA	according to UL	admissible power at $\cos \varphi = 0.5$
1	442 31	40	40	52
1	442 32	63	63	87
1	442 33	100	100	150
1	442 34	160	140	250
1	442 35	250	210	420
1	442 36	400	300	700
1	442 37	630	500	1700
1	442 38	1000	700	2000
1	442 39	1600	700	8500
1	442 40	2500	1400	3300

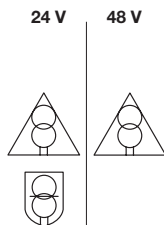

Pack	Cat. No.	Safety		
		12 - 24 V		
		230-400 V (primary) / 12 - 24 V (secondary)		
		Power (VA)	Primary terminal flexible cable (mm ²)	Secondary terminal flexible cable (mm ²)
1	428 40	40	1 to 4	1 to 4
1	428 41	63	1 to 4	1 to 4
1	428 42	100	1 to 4	1 to 4
1	428 43	160	1 to 4	1 to 4
1	428 44	220	1 to 4	1 to 4

Pack	Cat. No.	Accessories	
5	428 99	For clip on rail (90° mounting) of transformers up to 160 VA with 2 claws	
10	044 16	Plate Claw width 10 mm Threaded hole For M4 screw	

Pack	Cat. No.	Control and circuit isolation		
		115-230 V		
		115-230 V (secondary)		
		Supplied with 2 coupling strips		
		Primary 230-400 V \pm 15 V	Power in VA according to IEC and CSA	Instantaneous toadmissible power at $\cos \varphi = 0.5$
		\pm 15 V	IEC and CSA	UL
1	442 61	40	40	50
1	442 62	63	63	86
1	442 63	100	100	150
1	442 64	160	140	250
1	442 65	250	210	360
1	442 66	400	300	1100
1	442 67	630	500	1300
1	442 68	1000	700	2000
1	442 69	1600	700	6100
1	442 70	2500	1300	7100
1	442 71	4000	2400	11400
1	442 72	5000	3300	17500
1	442 73	6300	3700	10900
1	442 74	8000	4500	12500

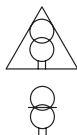

Control and signalling transformers

Single-phase

■ Dimensions

Fig. 1: 40 to 400 VA

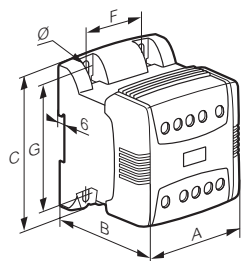

Fig. 2: 630 to 1000 VA

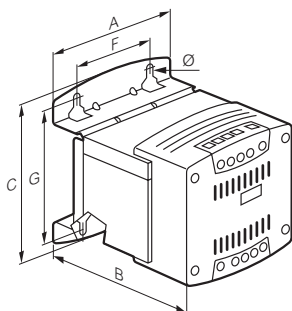

Fig. 3: 1600 to 2500 VA

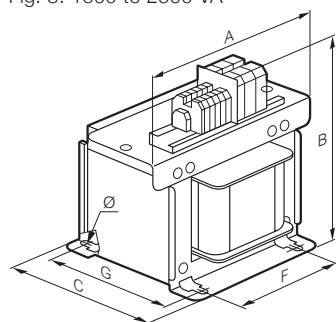
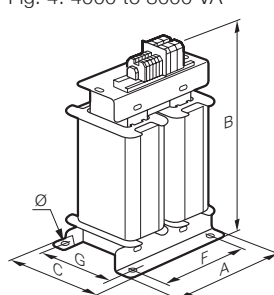
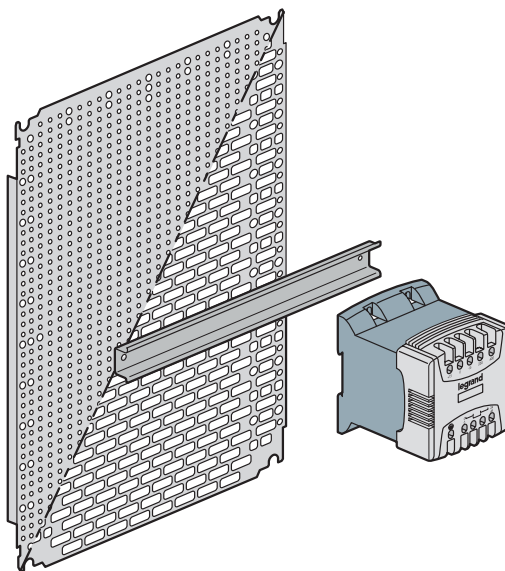

Fig. 4: 4000 to 8000 VA



■ Fixing

On perforated plates Lina 25 and on Lina 12.5 plates
On symmetrical rail 4 up to 250 VA
fixing centres pitch 25 mm up to 1000 VA



Attachment at 3 points possible with through oblong on the secondary side

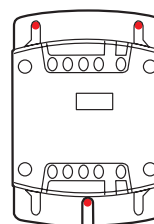

Cat. No.	Power (VA)	Fig.	Dimensions (mm)			Fixing ⁽¹⁾			Weight (Kg)
			A	B	C	F	G		
442 31/61	40	1	94	78	113	50	100	5.2	1.23
442 32/62	63	1	94	85	113	50	100	5.2	1.56
442 33/63	100	1	94	94	113	50	100	5.2	1.95
442 34/64	160	1	94	112	113	50	100	5.2	2.6
442 35/65	250	1	106	123	115	50	100	5.2	3.82
442 36/66	400	1	120	140	140	62.5	125	5.2	5.62
442 37/67	630	2	132	155	175	75	150	5.5	8
442 38/68	1000	2	150	199	206	100	175	7	14.9
442 39/69	1600	3	220	245	191	150	153	9	25.6
442 40/70	2500	3	300	292	171	200	114	9	33.1
442 71	4000	4	230	340	205	180	130	11	31
442 72	5000	4	240	390	205	180	130	11	40
442 73	6300	4	240	390	205	180	130	11	45
442 74	8000	4	240	390	280	180	140	11	64

(1) Direct fixing possibility on symmetrical rail 4 up to 250 VA

Control and signalling transformers

Single-phase

■ Characteristics

Single - phase 50-60 Hz - class I
 Insulation voltage between windings: 4 510 V
 Max. ambient operating temperature without derating: 50 ° C

Use of adjustment taps

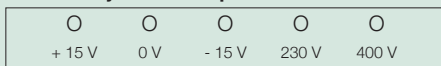

- 1) If $U_1 > 230$ or 400 V
- 2) If $I_2 < I_{2n}$ (if load is lower than rated load, the secondary voltage must be reduced)

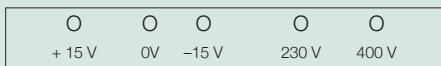

If $U_1 < 230$ or 400 V with a load $I_2 = I_{2n}$

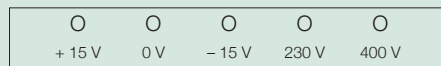

If $U_1 < 230$ or 400 V with a load $I_2 = I_{2n}$

Transformer sizing

$P_{inrush} = 0.8 (\sum P_m + \sum P_r + P_a)$
 $\sum P_m$ = Sum of all contactors holding powers
 $\sum P_r$ = Sum of all indicators light powers
 P_a = Inrush power of the largest contactor

Cat. No.	Power (VA)	Admissible instantaneous power (VA) at cos φ of:									No-load loss (W)	Loss at rated voltage ⁽¹⁾ (W)	Voltage drop (%) with cos φ of:			Efficiency (%) with cos φ of:			Ucc (%)	Connection			
		0.2	0.3	0.4	0.5	0.6	0.7	0.8	0.9	1			0.3	0.6	1	0.3	0.6	1		Primary cable (mm ²)		Secondary cable (mm ²)	
Primary 230-400 V ~ 15 V - Secondary 24-48 V																							
442 31	40	63	58	55	52	50	48	48	49	60	3.9	7.3	8.7	10.5	8.5	62.0	77.0	84.0	10.0	1 to 4	1 to 4	1 to 4	1 to 4
442 32	63	110	102	94	87	83	79	77	78	91	6.0	14.2	7.5	9.4	8.5	57.0	73.0	82.0	9.0	1 to 4	1 to 4	1 to 4	1 to 4
442 33	100	200	180	160	150	140	130	130	130	150	8.2	15.1	7.3	9.3	8.9	66.0	80.0	87.0	8.9	1 to 4	1 to 4	1 to 4	1 to 4
442 34	160	340	300	270	250	230	220	210	210	230	11.2	24.6	5.8	7.6	7.7	66.0	80.0	87.0	7.2	1 to 4	1 to 4	1 to 4	1 to 4
442 35	250	550	490	450	420	400	380	370	370	430	14.9	31.4	5.2	6.6	6.2	70.0	83.0	89.0	6.1	1 to 4	1 to 4	1 to 4	1 to 4
442 36	400	1400	1000	800	700	600	500	500	400	400	18.3	46.3	2.1	3.7	5.6	72.0	84.0	90.0	4.2	1 to 4	1 to 4	1 to 4	1 to 4
442 37	630	2200	1700	1400	1000	960	910	820	760	720	255	58	2.3	4	4.7	7.0	82	89	3.8	1 to 4	1 to 4	1 to 10	1 to 10
442 38	1000	3400	2800	2300	2000	1800	1600	1500	1400	1300	44.2	74.4	1.3	1.9	2.9	80.0	89.0	93.0	2.4	1 to 16	1 to 16	1 to 16	1 to 16
442 39	1600	12800	10900	9500	8500	7700	7100	6700	6400	6600	65.5	94.7	1.1	1.6	1.9	84.0	91.0	94.0	1.7	2.5 to 10	1.5 to 16	4 to 16	1.5 to 25
442 40	2500	4300	3900	3600	3300	3100	3000	2900	2900	3400	86.5	143.4	1.8	2.2	2.0	84.0	91.0	95.0	1.9	4 to 16	1.5 to 25	4 to 35	2.5 to 50
Primary 230-400 V ~ 15 V - Secondary 230 V and Primary 230-400 V + 15 V - Secondary 115-230 V																							
442 61	40	62	57	53	50	48	47	46	47	57	3.9	7.4	8.7	10.5	8.8	62.0	76.0	84.0	10.1	1 to 4	1 to 4	1 to 4	1 to 4
442 62	63	110	100	93	86	82	78	76	76	90	6.0	11.8	7.6	9.6	8.9	62.0	76.0	84.0	9.2	1 to 4	1 to 4	1 to 4	1 to 4
442 63	100	200	180	160	150	140	140	130	130	150	8.2	17.3	7.2	9.2	8.6	63.0	78.0	85.0	8.7	1 to 4	1 to 4	1 to 4	1 to 4
442 64	160	330	300	270	250	240	230	220	220	250	11.2	23.4	5.8	7.4	7.1	67.0	80.0	87.0	6.9	1 to 4	1 to 4	1 to 4	1 to 4
442 65	250	560	510	460	430	410	390	380	370	430	14.9	31.7	5.2	6.6	6.2	70.0	83.0	89.0	6.1	1 to 4	1 to 4	1 to 4	1 to 4
442 66	400	200	1600	1300	1100	900	840	760	700	660	18.3	43.9	2.1	3.6	5.2	73.0	85.0	90.0	4.1	1 to 4	1 to 4	1 to 4	1 to 4
442 67	630	2300	1800	1500	1300	1100	1000	910	840	810	25.5	75.7	2.1	3.5	4.8	71	83	89	3.4	1 to 4	1 to 4	1 to 10	1 to 10
442 68	1000	3400	2800	2300	2000	1800	1600	1500	1400	1300	44.2	73.6	1.3	2.0	2.7	80.0	89.0	93.0	2.2	1 to 16	1 to 16	1 to 16	1 to 16
442 69	1600	8700	7500	6600	6100	5400	5000	4700	4500	4700	65.5	95.3	1.1	1.5	1.8	83.0	91.0	94.0	1.5	2.5 to 10	1.5 to 16	2.5 to 10	1.5 to 16
442 70	2500	9200	8300	7600	7100	6700	6300	6200	6100	7100	86.5	150.1	1.8	2.3	2.2	83.0	91.0	94.0	2.0	4 to 16	1.5 to 25	4 to 16	1.5 to 25
442 71	4000	16500	14300	12700	11400	10500	9800	9200	8900	9500	87.4	234.8	2.1	2.9	3.3	84.0	91.0	94.0	2.7	4 to 16	1.5 to 25	4 to 16	1.5 to 25
442 72	5000	28500	23400	19900	17500	15600	14200	13100	12300	12300	87.4	279.0	1.5	2.3	2.9	84.0	91.0	95.0	2.3	4 to 16	1.5 to 25	4 to 16	1.5 to 25
442 73	6300	17200	14500	12500	10900	10000	9200	8600	8100	8300	120	530	2.8	4.1	4.8	78	88	92	3.9	4 to 16	1.5 to 25	4 to 16	1.5 to 25
442 74	8000	19800	18600	14400	12500	11500	10600	9800	9300	9600	195	350	1.7	2.7	3.7	87	93.0	96.0	2.9	4 to 16	1.5 to 25	4 to 16	1.5 to 25

(1) Total losses at nominal voltage

Equipment

Single-phase

■ Characteristics

- Insulation voltage:
- between windings: 4 470 V
 - between primary and earth: 2 240 V
 - between secondary and earth: 250 V for 12 and 24 V

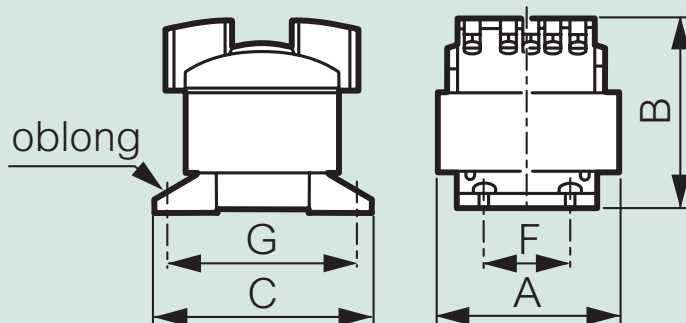

Fig. 1

Cat. No.	Power (VA)	AIO (VA) cos 0.5	Fig.	Dimensions (mm)			Fixing (mm)			Weight (kg)	No load loss (W)	Total losses at 100% load (W)	Voltage drop (%)		Efficiency (%)		Ucc (%)	Connection PRI			Connection SEC		
				A	B	C	F	G	∅				cos ∅ 1	cos ∅ 0.45	cos ∅ 1	cos ∅ 0.45		flexible	rigid	lug ∅ (mm)	flexible	rigid	lug (mm)
Single-phase safety transformers: Primary 230-400 V - Sec 12-24 V																							
428 40	40	55	1	84	70	98	40	86	4.5	0.9	3.7	13.1	18.3	12.7	0.75	0.58	15.6	1 to 4	1 to 4	4,5	1 to 4	1 to 4	4,5
428 41	63	91	1	84	77	98	40	86	4.5	1.3	4.9	16.3	13.5	10.2	0.79	0.64	11.8	1 to 4	1 to 4	4,5	1 to 4	1 to 4	4,5
428 42	100	140	1	84	86	98	40	86	4.5	1.6	6.2	21.0	10.5	8.7	0.83	0.68	9.5	1 to 4	1 to 4	4,5	1 to 4	1 to 4	4,5
428 43	160	205	1	84	104	98	40	86	4.5	2.4	9.1	31.8	8.8	7.4	0.83	0.69	7.9	1 to 4	1 to 4	4,5	1 to 4	1 to 4	4,5
428 44	220	290	1	96	115	110	40	98	4.5	3.4	12.6	40.0	6.9	6.3	0.85	0.71	6.5	1 to 4	1 to 4	4,5	1 to 4	1 to 4	4,5

Protection of transformers and their lines

■ Protection of lines

General

Lines must be protected against overloads and short-circuits. Protection against overloads is only compulsory if the line is likely to be affected by an overload current. This protection can be installed at the head or end of the line. Protection against short-circuits is compulsory in all installations ; this protection has to be installed at the head of the line

Supply line (transformer primary)

The transformer is a device that cannot generate overloads. Its supply line requires protection against short-circuits only. When a transformer is energised, a very high inrush current is produced (in the region of 25 In) for approximately 10 ms. The line protection must take these 2 factors into consideration. Legrand offers 3 possibilities: aM fuse cartridges, type D MCBs (average value of the magnetic 12 In, with a standard adjustment range between 10 and 14 In), type C MCBs (average value of the magnetic 7 In, with a standard adjustment range between 5 and 10 In)

Minimal protection rating for primary supply line on transformer⁽¹⁾

Power	230 V single - phase				400 V single - phase		
	aM Cartridge	MCBs C curve or MCCBs	MCBs D curve or MCCBs	type B MCB with inrush current limiter	aM Cartridge	MCBs C curve or MCCBs	MCBs D curve or MCCBs
40 VA	0,5 A 130 95	1 A 064 60		1 A 067 52	0,25 A 130 92	1 A 064 60	
63 VA	1 A 130 01	2 A 064 61		1 A 067 52	0,5 A 130 95	1 A 064 60	
100 VA	1 A 130 01	3 A 064 62	1 A 066 25	1 A 067 52	1 A 130 01	2 A 064 61	1 A 066 25
160 VA	2 A 130 02	6 A 064 64	2 A 066 26	1 A 067 52	1 A 130 01	2 A 064 61	1 A 066 25
220 VA	2 A 130 02	6 A 064 64	2 A 066 26	2 A 067 53	1 A 130 01	3 A 064 62	2 A 066 26
250 VA	2 A 130 02	6 A 064 64	3 A 066 27	2 A 067 53	2 A 130 02	3 A 064 62	2 A 066 26
310 VA	4 A 130 04	10 A 064 66	3 A 066 27	2 A 067 53	2 A 130 02	6 A 064 64	2 A 066 26
400 VA	4 A 130 04	10 A 064 66	6 A 066 29	2 A 067 53	2 A 130 02	6 A 064 64	2 A 066 26
450 VA	4 A 130 04	10 A 064 66	6 A 066 29	3 A 067 54	2 A 130 02	6 A 064 64	3 A 066 27
630 VA	6 A 130 06	16 A 064 68	6 A 066 29	3 A 067 54	4 A 130 04	10 A 064 66	6 A 066 29
800 VA	6 A 130 06	16 A 064 68	10 A 066 31	6 A 067 56	4 A 130 04	10 A 064 66	6 A 066 29
1000 VA	10 A 130 10	20 A 064 69	10 A 066 31	6 A 067 56	4 A 130 04	16 A 064 68	6 A 066 29
1250 VA	10 A 130 10	25 A 064 70	16 A 066 33	6 A 067 56	6 A 130 06	16 A 064 68	10 A 066 31
1600 VA	10 A 130 10	32 A 064 71	16 A 066 33	10 A 067 58	6 A 130 06	20 A 064 69	10 A 066 31
2000 VA	12 A 130 12	40 A 064 72	20 A 066 34	10 A 067 58	10 A 130 08	25 A 064 70	16 A 066 33
2500 VA	16 A 130 16	50 A 064 73	25 A 066 35	16 A 067 60	10 A 130 10	32 A 064 71	16 A 066 33

■ Protection of transformers

According to IEC/EN 61558 standards, transformers must be protected against overloads and short-circuits which may occur during normal operations

The standards do not specify the location or type of protective device: it is the manufacturer's responsibility to select the most suitable position, either on the primary or secondary side

Legrand has selected secondary protection. The rating, type and location of the protective device are indicated on the front of its devices

Single-phase: Control, safety isolating, isolating, equipment and installation transformers

Nominal power IEC and CSA	12 V				24 V				48 V				115 V				230 V				
	Rating	Cartridge Cat.Nos	Rating	MCBS Cat.Nos	Rating	Cartridge Cat.Nos	Rating	MCBS Cat.Nos	Rating	Cartridge Cat.Nos	Rating	MCBS Cat.Nos	Rating	Cartridge Cat.Nos	Rating	MCBS Cat.Nos	Rating	Cartridge Cat.Nos	Rating	MCBS Cat.Nos	
40 VA	4	T4 AL ⁽¹⁾	4	T4 AL ⁽¹⁾	2	T2 AL ⁽¹⁾	2	T2 AL ⁽¹⁾	1	T1 AL ⁽¹⁾	1	T1 AL ⁽¹⁾	0,4	T0,4 AL ⁽¹⁾	0,4	T0,4 AL ⁽¹⁾	0,2	T0,2 AL ⁽¹⁾	0,2	T0,2 AL ⁽¹⁾	
63 VA	5	T5 AL ⁽¹⁾	5	T5 AL ⁽¹⁾	2,5	T2,5 AL ⁽¹⁾	2,5	T2,5 AL ⁽¹⁾	1,25	T1,25 AL ⁽¹⁾	1,25	T1,25 AL ⁽¹⁾	0,5	T0,5 AL ⁽¹⁾	0,5	T0,5 AL ⁽¹⁾	0,25	T0,25 AL ⁽¹⁾	0,25	T0,25 AL ⁽¹⁾	
100 VA	8	T8 AE ⁽¹⁾	8	063 93	4	T4 AE ⁽¹⁾	4	063 91	2	T2 AL ⁽¹⁾	2	063 89	0,8	T0,8 AL ⁽¹⁾	1	063 88	0,4	T0,4 AL ⁽¹⁾	0,5	063 86	
160 VA	16	133 16	13	063 95	8	133 08	6	063 92	3,15	T3,15 AE ⁽¹⁾	4	063 91	1,6	T1,6 AL ⁽¹⁾	2	063 89	0,63	T0,63 AL ⁽¹⁾	1	063 88	
220 VA	20	133 20	20	063 97	10	133 10	10	063 94	5	T5 AE ⁽¹⁾	6	063 92	2	T2 AL ⁽¹⁾	2	063 89	1	T1 AL ⁽¹⁾	1	063 88	
250 VA	20	133 20	20	063 97	10	133 10	10	063 94	6	133 06	6	063 92	2	T2 AL ⁽¹⁾	2	063 89	1	T1 AL ⁽¹⁾	1	063 88	
310 VA	25	133 25	25	063 98	12	133 12	13	063 95	6	133 06	6	063 92	2,5	T2,5 AE ⁽¹⁾	3	063 90	1,25	T1,25 AL ⁽¹⁾	2	063 89	
400 VA	32	143 32	32	063 99	16	133 16	16	063 96	8	133 08	8	063 93	4	133 04	4	063 91	2	133 02	2	063 89	
450 VA	40	143 40	40	064 00	20	133 20	20	063 97	10	133 10	10	063 94	4	133 04	4	064 91	2	133 02	2	063 89	
630 VA	50	143 50	50	063 81	25	133 25	25	063 98	12	133 12	13	063 95	6	133 06	6	063 92	4	133 04	3	063 90	
800 VA	63	153 63	63	063 82	32	143 32	32	063 99	16	133 16	16	063 96	8	133 08	8	063 93	4	133 04	4	063 91	
1000 VA	80	153 80	80	063 83	40	143 40	40	064 00	20	133 20	20	063 97	8	133 08	8	063 93	4	133 04	4	063 91	
1250 VA	100	153 96	100	064 76	50	143 50	50	063 81	25	133 25	25	063 98	10	133 10	10	064 94	6	133 06	6	063 92	
1600 VA	125	153 97	125	064 77	63	153 63	63	063 82	32	143 32	32	063 99	16	133 16	13	064 95	8	133 08	8	063 93	
2000 VA				160		80	153 80	80	063 83	40	143 40	40	064 00	16	133 16	16	063 96	8	133 08	8	063 93
2500 VA				200		100	153 96	100	064 76	50	143 50	50	063 81	20	133 20	20	063 97	10	133 10	10	063 94

(1) Fuses IEC 127 (cartridge 5 x 20 T type)

■ Main transformer functions:

• Changing voltage:

Isolation transformer (basic insulation between primary and secondary)

Auto-transformer (no insulation between primary and secondary)

• Control circuit power supply

Control transformer (basic insulation between primary and secondary)

• Protection against electric shock

- Protection against direct and indirect contact by:

Safety isolating transformers (reinforced insulation between primary and secondary, no-load voltage < 50 V)

- Protection against indirect contact by:

Isolating transformers (reinforced insulation between primary and secondary)

Isolating transformers For the supply of medical location (group II)

The transformer function(s) can either be defined by the equipment designer or can be imposed by installation guidelines or the equipment standard

Definitions:

- Electric shocks: physiological effect resulting from an electrical current through a human or animal body (IEV 195-01-04)
- Direct contact: electric contact of persons or animals with live parts (195-06-03)
- Indirect contact: electric contact of persons or animals with exposed-conductive-parts which have become live under fault conditions (195-06-04)

Some items sold separately

For pack quantity, please refer to numerical index pages

For trade price, please see your local HPM Legrand representative for the current price list

Filtered rectified power supplies

Single phase – DC



470 02



470 23



470 24

Provide voltage for P.L.C and associated output devices that require 12V or 24V DC.

Units consist of:

- . Safety isolating transformers with electrostatic screen
- . Double terminals on each polarity
- . Fitted with filter capacitors
- . Secondary protected by fuse
- . Green indicator for presence of operating voltage.

Supplied with isolated coupling bar for fast connection between the - and the earth terminal up to 15A.

Approval No. C96864N.

Conforms to the following standards: IEC and EN 61558-2-6, UL 60950 and CAN/CSA-C22.2 no 60 950.00. Product is created to adapt to equipment which conform to the following standards: EN 61131-2, EN 60204 and EN 60439-1

Single phase power supplies

DC

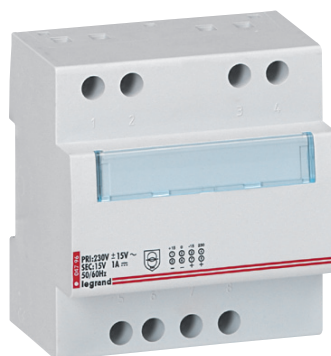

4 131 05



Dimensions (p. 157)

For supplying PLCs and their peripherals or any use requiring a voltage of 12 V or 24 V=
Fixing on DIN rail

Pack Cat. No. Filtered rectified power supplies

Conform to standards IEC EN 61558-2-6
For equipment conforming to standards EN 61131-2, EN 60204 and EN 60439-1

Comprising:

- A safety transformer with interference filtration
- A filter capacitor
- Protection by PTC integrated in the primary
- Double operating terminals

Terminal capacity: 6 mm² flexible

Class II after addition of faceplate

Ripple factor < 3%

Ambient temperature without derating: 60 ° C

Power supply 230 V ± 15 V~

12 V=

Pack	Cat. No.	Power (W)	Current (A)	Number of modules
1	4 131 05	15	1.3	5
1	4 131 07	12	0.5	5
1	4 131 08	21.5	0.9	5

24 V=

Pack Cat. No. Single phase

12 V=

230-400 V ± 15 V~ (primary) / 12 V= (secondary)

Output (W)	Current (A)	Terminal capacity flexible cable	
		Entry	Exit
12	1	6	6
30	2.5	6	6
60	5	6	6
120	10	6	6
300	25	6	10

24 V=

230-400 V ± 15 V~ (primary) / 24 V= (secondary)

Output (W)	Current (A)	Terminal capacity flexible cable	
		Entry	Exit
12	0.5	6	6
24	1	6	6
60	2.5	6	6
120	5	6	6
240	10	6	6
360	15	6	6
600	25	6	10
960	40	6	16
1 200	50	16	16

Single phase power supplies

■ Filtered rectified power supplies

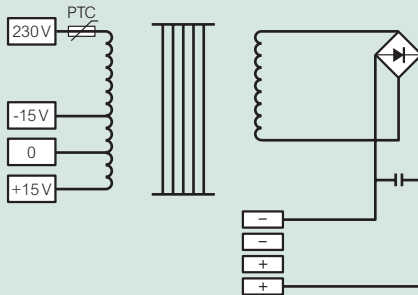

Cat. No.	Voltage (V)	Current (A)	Weight (Kg)	I Prim. on load (A) at 230 V
047 95	12	1.3	0.95	0.15
047 97	24	0.5	0.95	0.13
047 98	24	0.9	0.95	0.17

Cat. No.	Voltage of use				No load losses (W)	Total losses at 100% load (W)	Voltage drop $\cos \varphi = 1$
	No load (V)	On load (V)	with 100 kA load and prim. voltage + 10%	with nominal load and prim. voltage - 15%			
047 95	15.1	11.8	16.3	10.4	3.4	8.7	28.5
047 97	28.9	23.6	30.6	20.7	3.4	7.1	22.3
047 98	29.9	22.8	32.0	20.3	3.4	10.4	31.0

■ PTC protection

PTC: Positive temperature coefficient (limitation of overloads and temperature). In the event of an overload switch "off" the power supply and allow the power supply to cool down before switching on again

Bell transformers



4130 91

Pack Cat. No. Bell transformers

Conform to IEC / EN 61558-2-8

Protected against overloads and short circuits.

In the event of an overload, switch "OFF" the power supply and allow the transformer to cool down before switching on again
With label holders
Wall or rail mounting (for 4 modules)

Possibility for supply busbars to run through (Cat.No 042 25)

230 V/12 V - 8 V

Pack	Cat. No.	Secondary (V)	Rating (A)	Power (VA)	Number of modules
1	4 130 91	12/8	0.66/1	8	2
1	4 130 92	12/8	2/3	24	4
230 V/24 V - 12 V					
1	4 130 93	24/12	1/1.5	24 - 18	4

Filtered rectified power supplies

Single phase

Measurements and electrical characteristics

Fig. 1

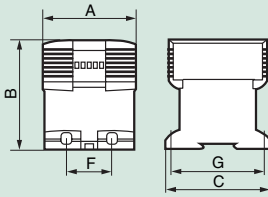

Fig. 2

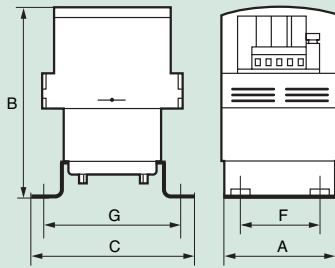

Fig. 3

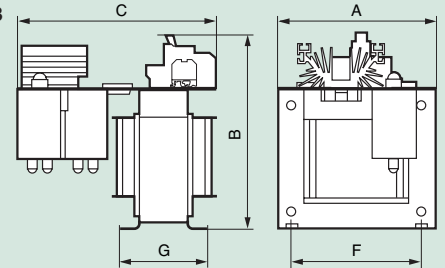
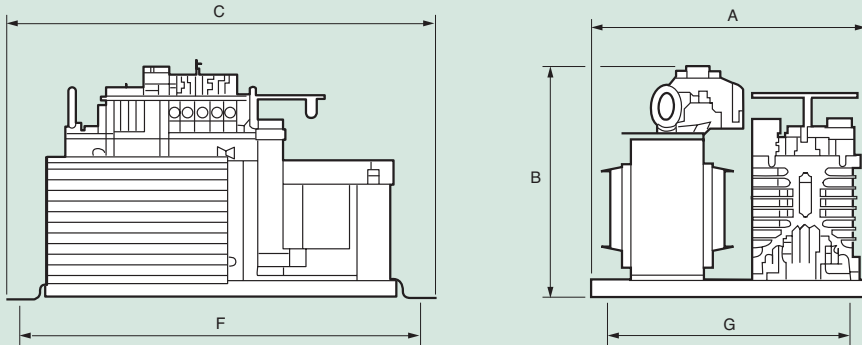

Fig. 4



Single phase power supplies primary 230/400 V ± 15 V tapping

Cat. No.	Voltage (V)	Amps (A)	Fig	Dimensions (mm)			Fixing (mm)			Weight (Kg)	Primary on-load current (A)		Operating voltage				No load losses (W)	Total loss at 100% load (W)	Voltage drop (%)
				A	B	C	F	G	Diameter		at 230V	at 400V	No load (V)	Onload (V)	Onload 100mA and primary +10%	Nominal on-load 100mA and primary -15%			
Secondary 12 V																			
470 01	12	1	1	68	98	88	-	-	-	1	0.12	0.06	14.4	11.7	15.5	10.3	4.4	7.3	23.5
470 02	12	2.5	1	93	121	105	45	94	4.6	2.45	0.33	0.19	13.9	11.6	15.2	10.2	8.3	11.9	19.4
470 03	12	5	1	105	135	115	45	104	4.6	3.6	0.60	0.34	14.1	12.1	15.5	10.5	11.4	17.1	17.2
470 04	12	10	2	126	186	175	75	150	5.5	6.35	1.24	0.72	14.7	11.8	16.1	10.4	20.2	33.7	24.7
470 06	12	25	3	180	220	270	122	100	7	11	2.13	1.22	14.7	11.71	16.1	10.3	24.2	47	25
Secondary 24 V																			
470 20	24	0.5	1	68	98	88				1	0.12	0.06	27.6	22.9	29.4	20.1	4.4	7.3	20.66
470 21	24	1	1	68	98	88				1	0.18	0.10	29.0	22.8	31.2	20.2	4.4	10.3	27.03
470 22	24	2.5	1	93	121	105	45	94	4.6	2.45	0.47	0.27	27.8	23.3	30.4	20.4	8.3	16.3	19.46
470 23	24	5	1	105	135	115	45	104	4.6	3.6	0.88	0.51	27.5	23.2	30.2	20.3	11.4	25.4	18.68
470 24	24	10	2	126	186	175	75	150	5.5	6.35	1.88	1.09	27.7	23.5	30.5	20.5	20	45.3	18.20
470 25	24	15	2	126	206	175	75	150	5.5	7.6	2.53	1.46	27.5	23.2	30.2	20.2	23	54.7	18.70
470 26	24	25	3	180	270	290	150	125	9	18.1	4.70	2.70	27.9	23.7	30.5	20.9	33.2	65.2	17
470 28	24	40	4	310	265	478	445	200	7	50	6.20	3.60	28.4	23.2	31.2	20.4	230	340	22.41
470 29	24	50	4	335	315	575	542	200	7	60	7.20	4.10	25.4	23.5	27.9	20.2	194	340	8.09

Single phase Lexic power supplies primary 230 V± 15 V tapping

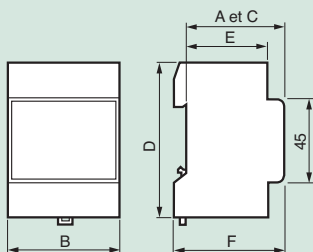

Cat. No.	Voltage (V)	Amps (A)	Dimensions (mm)						Weight (Kg)	Primary on-load current (A) at 230V	Operating voltage				No load losses (W)	Total losses at 100% load (W)	Variation (%)	Voltage drop (%)
			A	B	C	D	E	F			No load (V)	On load (V)	Onload 100mA and primary +10%	Nominal onload and primary -15%				
4 131 05	12	1.3	60	89	60	95	44	66	1	0.15	15.1	11.8	16.3	10.4	3.4	8.7	< 5	28.5
4 131 07	24	0.5	60	89	60	95	44	66	1	0.13	28.9	23.6	30.6	20.7	3.4	7.1	< 5	22.3
4 131 08	24	0.9	60	89	60	95	44	66	1	0.17	29.9	22.8	32.0	20.3	3.4	10.4	< 5	31.0

Viking™ 3 terminal blocks with screw connection and accessories

For copper cable

				ELECTRICAL FUNCTION
371 61 371 63 371 64 371 66 371 69 371 68 371 00 371 08 371 20 371 30	Connecting (p. 162)	1 connection - 1 entry/1 outlet		
		1 connection - 2 entries/2 outlets		
		2 connections on 2 levels		
		3 connections on 3 levels		
371 71 371 76 371 78 371 79	For protection conductor (p. 162)	1 connection - 1 entry/1 outlet - metal base		
		1 connection - 1 entry/1 outlet - plastic base ⁽¹⁾		
		1 connection - 2 entries/2 outlets - metal base		
371 80 371 81 371 84 371 86 371 87	Disconnect (p. 163)	1 connection		Open (to be equipped)
				For fuse cartridge 5 x 20 with handle lever
				For fuse cartridge 5 x 20 with handle lever + blown fuse indicator
				For neutral circuit with handle lever
				For standard circuit
				For circuit not broken
				For fuse cartridge 5 x 20 with screwed plug
				For fuse cartridge 6.3 x 32 with screwed plug
371 53 371 56	Function blocks (p. 163)	1 connection		Modular
		2 connections on 2 levels		Diode carrier 1N4007
				With voltage presence LED
371 51 371 52 371 92	For sensor and actuator (p. 163)	3 connections on 3 levels		Sensor
				Actuator
	PNE (p. 163)			Phase/Neutral/Earth
Measurement (p. 163)		1 connection		Disconnect for measuring circuit





(1) Can be used for protection conductor inside class II equivalent assemblies
 (2) Blown fuse indicator 12/24/48 V~/. Cat.No 375 24 or 110/250 V~/. Cat.No 375 25
 (3) Or end stop Cat.No 375 10

(4) Upper level
 (5) Lower level only
 (6) Lower and intermediate levels

Some items sold separately

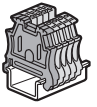
For pack quantity, please refer to numerical index pages

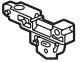
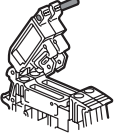
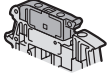
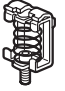
For trade price, please see your local HPM Legrand representative for the current price list



TERMINAL BLOCKS				INSULATION		EQUIPOTENTIAL LINK					PROTECTION		MEASURE- MENT	ASSOCIATED PRODUCTS							
Nominal cross-section (mm ²)	Pitch (mm)	Colour	Cat. No.	End cap	Separation and insulation divider	Comb for 2 blocks, auto. front	Comb for 3 blocks, auto. front	Comb for 10 blocks, auto. front	Comb for 12 blocks, side	Bar for 12 blocks, front	Single pole screen	Cut to length screen	Test socket								
2.5	5	● 371 60	371 60 ^(a)	375 60	375 02	375 01					375 65	375 68	375 27	 End stops (p. 166)							
		● 371 00																			
		● 371 20																			
		● 371 30																			
4	6	● 371 61	371 60 ^(a)	375 60	375 05	375 04					375 65	375 68	375 27								
		● 371 01																			
		● 371 21																			
		● 371 31																			
6	8	● 371 62	371 60 ^(a)	375 60	375 08	375 07					375 66	375 68	375 27	 Label holder for end stop (p. 166)							
		● 371 02																			
		● 371 78																			
10	10	● 371 63	371 60 ^(a)	375 60						375 40	375 66	375 68	375 75								
		● 371 03																			
16	12	● 371 64	371 51	375 61						375 42	375 67	375 69	375 76								
		● 371 04																			
35	15	● 371 65	371 51	375 61						375 44	375 67	375 69	375 76								
		● 371 05																			
70	22	● 371 66	built-in																		
4	6	● 371 69	371 52	375 62	375 05	375 04							375 27	 Handle lever mini lever (p. 167)							
		● 371 09																			
2.5	5	● 371 67	371 53	375 63	375 02	375 01							375 27 ⁽⁴⁾								
		● 371 07																			
4	6	● 371 68	371 53	375 63	375 05	375 04							375 27 ⁽⁴⁾								
		● 371 08																			
2.5	5	● 371 51	371 54	375 54	375 02 ⁽⁴⁾	375 01 ⁽⁴⁾	375 46 ^(b)	375 47 ^(b)					375 27 ⁽⁴⁾								
		● 371 70																			
4	6	● 371 71	371 50 ^(a)	375 51										 Joining rods for disconnect blocks (p. 167)							
6	8	● 371 72																			
10	10	● 371 73																			
16	12	● 371 74																			
35	15	● 371 75																			
35	15	● 371 76																			
4	6	● 371 77	371 50 ^(a)	375 60	375 05	375 04					375 65	375 68									
		● 371 78	371 50 ^(a)	375 60	375 08	375 07					375 66	375 68									
4	6	● 371 79	371 52																		
2.5	6	● 371 80	371 55	375 62	375 05	375 04							375 27	 Blown fuse indicators (p. 167)							
		● 371 81																			
		● 371 81 + 371 24/25 ^(a)																			
		● 371 82																			
		● 371 83																			
		● 371 84													375 55	375 62	375 05	375 04			375 27
		● 371 85													375 55	375 62	375 05	375 04			
● 371 86	375 55	375 62	375 05	375 04			375 27														
10	12	● 371 87	371 56											 Shielding (p. 167)							
		● 371 88																			
2.5	5	● 371 53	371 55		375 02	375 01							375 27								
		● 371 54																			
4	6	● 371 55	371 53	375 63	375 05	375 04							375 27 ⁽⁴⁾								
		● 371 56													375 63	375 05 ⁽⁴⁾	375 04 ⁽⁴⁾				
2.5	5	● 371 51	371 54	375 54	375 02 ⁽⁴⁾	375 01 ⁽⁴⁾	375 46 ^(b)	375 47 ^(b)					375 27 ⁽⁴⁾	 CAB 3 (p. 180)							
		● 371 52																			
4	8	● 371 92	371 57										375 77								

Viking™ 3 terminal blocks with spring connection and accessories

For copper cable

		ELECTRICAL FUNCTION		
372 60 372 61 372 64 372 40 372 69 372 68 372 02 372 47 372 21 372 42	Connecting (p. 164)	1 connection - 2 wires - 1 entry/1 outlet		
		1 connection - 3 wires - 1 entry/2 outlets		
		1 connection - 4 wires - 2 entries/2 outlets		
		2 connections - 4 wires - 2 levels		
372 70 372 71 372 72 372 12	For protection conductor (p. 164)	1 connection - 2 wires - 1 entry/1 outlet - metal base		
		1 connection - 3 wires - 1 entry/2 outlets - metal base		
		1 connection - 4 wires - 2 entries/2 outlets - metal base		
372 80 372 82 372 83 372 84	Disconnect (p. 165)	1 connection 2 wires	Open (to be equipped)	
			For fuse cartridge 5 x 20 with handle lever	
			For fuse cartridge 5 x 20 with handle lever + blown fuse indicator	
			For neutral circuit with handle lever	
			For standard circuit	
			For circuit not broken	
372 54	Function blocks (p. 165)	1 connection 4 wires 2 entries/2 outlets	Diode carrier 1N4007	
		2 connections 4 wires 2 levels	Diode carrier 1N4007	
			With voltage presence LED	

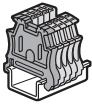
(1) Blown fuse indicator 12/24/48V~/. Cat.No 375 24 or 110/250V-. Cat.No 375 25, (2) Lower level only, (3) Upper level only

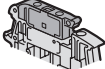
TERMINAL BLOCKS				INSULATION		EQUIPOTENTIAL LINK			MEASUREMENT	ASSOCIATED PRODUCTS
Nominal cross-section (mm ²)	Pitch (mm)	Colour	Cat. No.	End cap	Separation and insulation divider	Comb for 2 blocks	Comb for 3 blocks	Comb for 10 blocks	Test socket	
4	5	● 372 60	372 60	375 86	375 95	375 02		375 01	375 27	 End stops (p. 166)
		● 372 00								
		● 372 20								
4	6	● 372 61	372 61	built-in	375 95	375 05		375 04	375 27	
		● 372 01								
		● 372 21								
6	8	● 372 62	372 62	built-in		375 08	375 07		375 27	
		● 372 02								
10	10	● 372 63	372 63	built-in		375 82				
		● 372 03								
16	12	● 372 64	372 64	built-in		375 85				
		● 372 04								
4	5	● 372 40	372 40	375 87	375 95	375 02		375 01	375 27	 Label holder for end stop (p. 166)
		● 372 41								
		● 372 42								
4	6	● 372 43	372 43	built-in	375 95	375 05		375 04	375 27	
		● 372 44								
4	5	● 372 46	372 46	375 88	375 95	375 02		375 01	375 27	
		● 372 47								
4	6	● 372 69	372 69	built-in		375 05		375 04	375 27	
		● 372 09								
4	5	● 372 67	372 67	375 89	375 96	375 02		375 01	375 27 ^(a)	
		● 372 07								
4	6	● 372 68	372 68	built-in	375 96	375 05		375 04	375 27 ^(a)	
		● 372 08								
4	5		372 70	375 86						
4	6		372 71	built-in						
6	8		372 72							
10	10		372 73							
16	12	● 372 74	372 74							
4	5		372 10		375 87					
4	6		372 11	built-in						
4	5		372 12	375 88						
4	6		372 79	built-in						
2.5	6	● 372 80	372 80	375 90		375 05		375 04	375 27	 Blown fuse indicators (p. 167)
		● 372 81								
		● 372 81+ 375 24/25 ^(b)								
		● 372 82								
		● 372 83								
		● 372 84								
		● 372 85								
● 372 86										
4	5	● 372 54	372 54	375 88	375 95	375 02		375 01		
		● 372 55		375 89	375 96	375 02		375 01		
		● 372 56		375 89	375 96	375 02 ^(b)		375 01 ^(b)		

Viking™ 3 terminal blocks with screw connection



371 60 + 371 00 + 371 20 + 371 30



371 69

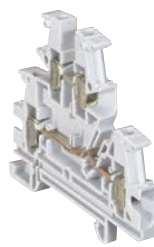

371 68



371 70 on rail



371 74



371 76



371 79

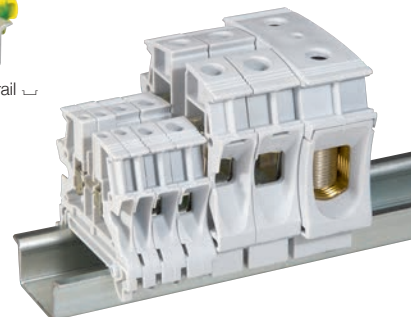

371 60 + 371 61 + 371 62 + 371 63 + 371 64 + 371 65 + 371 66

Technical characteristics (p. 168)
 Approvals (p. 168)

Used to make the electrical connection between 2 rigid or flexible copper wires. 2 areas for bridging combs for alternating equipotential connection up to 8 pitch. For rails \hookleftarrow depth 15 mm, \hookleftarrow EN 60715 depth 7.5 mm and 15 mm

Pack **Cat. No.** **Connecting**

Pack	Cat. No.	Colour	Nominal cross-section (mm ²)	Capacity		Pitch (mm)	
				Rigid wire (mm ²)	Flexible wire (mm ²)		
1 connection - 1 entry/1 outlet							
60	371 60	Grey	2.5	0.25 to 4	0.25 to 2.5	5	
60	371 00	Blue					
60	371 20	Orange					
60	371 30	Red					
50	371 61	Grey	4	0.25 to 6	0.25 to 4	6	
50	371 01	Blue					
50	371 21	Orange					
50	371 31	Red	6	0.5 to 10	0.25 to 6	8	
40	371 62	Grey					
40	371 02	Blue					
30	371 63	Grey					
30	371 03	Blue	10	1.5 to 16	2.5 to 10	10	
20	371 64	Grey					
20	371 04	Blue	16	1.5 to 25	4 to 16	12	
20	371 65	Grey					
20	371 05	Blue	35	2.5 to 50	4 to 35	15	
10	371 66 ⁽¹⁾	Grey					
10	371 66 ⁽¹⁾	Grey	70	25 to 95	16 to 70	22	
1 connection - 2 entries/2 outlets							
25	371 69	Grey	4	0.25 to 6	0.25 to 4	6	
25	371 09	Blue					
2 connections on 2 levels							
60	371 67	Grey	2.5	0.25 to 4	0.25 to 2.5	5	
60	371 07	Blue					
60	371 68	Grey	4	0.25 to 6	0.25 to 4	6	
60	371 08	Blue					
3 connections on 3 levels							
50	371 51 ⁽²⁾	Grey	2.5	0.25 to 4	0.25 to 2.5	5	

Pack **Cat. No.** **For protection conductor**

Pack	Cat. No.	Colour	Nominal cross-section (mm ²)	Capacity		Pitch (mm)	
				Rigid wire (mm ²)	Flexible wire (mm ²)		
1 connection - 1 entry/1 outlet - metal base							
Screwless fixing on rail up to 10 mm pitch PEN from 10 mm ²							
60	371 70	Green/yellow	2.5	0.25 to 4	0.25 to 2.5	5	
50	371 71	Green/yellow	4	0.25 to 6	0.25 to 4	6	
40	371 72	Green/yellow	6	0.5 to 10	0.25 to 6	8	
30	371 73	Green/yellow	10	1.5 to 16	2.5 to 10	10	
10	371 74	Green/yellow	16	1.5 to 25	4 to 16	12	
10	371 75	Green/yellow	35	2.5 to 50	4 to 35	15	
1 connection - bare block - metal base							
10	371 76	-	35	2.5 to 50	4 to 35	15	
1 connection - 2 entries/2 outlets - metal base							
Screwless fixing on rail							
50	371 79	Green/yellow	4	0.25 to 6	0.25 to 4	6	
1 connection - 1 entry/1 outlet - plastic base							
Can be used for protection conductor inside class II equivalent assemblies							
50	371 77	Green	4	0.25 to 6	0.25 to 4	6	
40	371 78	Green	6	0.5 to 10	0.25 to 6	8	

PNE - Phase/Neutral/Earth

Pack	Cat. No.	Colour	Nominal cross-section (mm ²)	Capacity		Pitch (mm)	
				Rigid wire (mm ²)	Flexible wire (mm ²)		
3 connections on 3 levels - metal base							
Green/yellow marking for the lower level Screwless fixing on rail							
50	371 52	Grey	2.5	0.25 to 4	0.25 to 2.5	5	

(1) Built-in end cap

(2) Rigid wire capacity: 2.5 mm² max. with equipotential bridging comb



CAB3 marking system (p. 180)

Viking™ 3 terminal blocks with screw connection (continued)

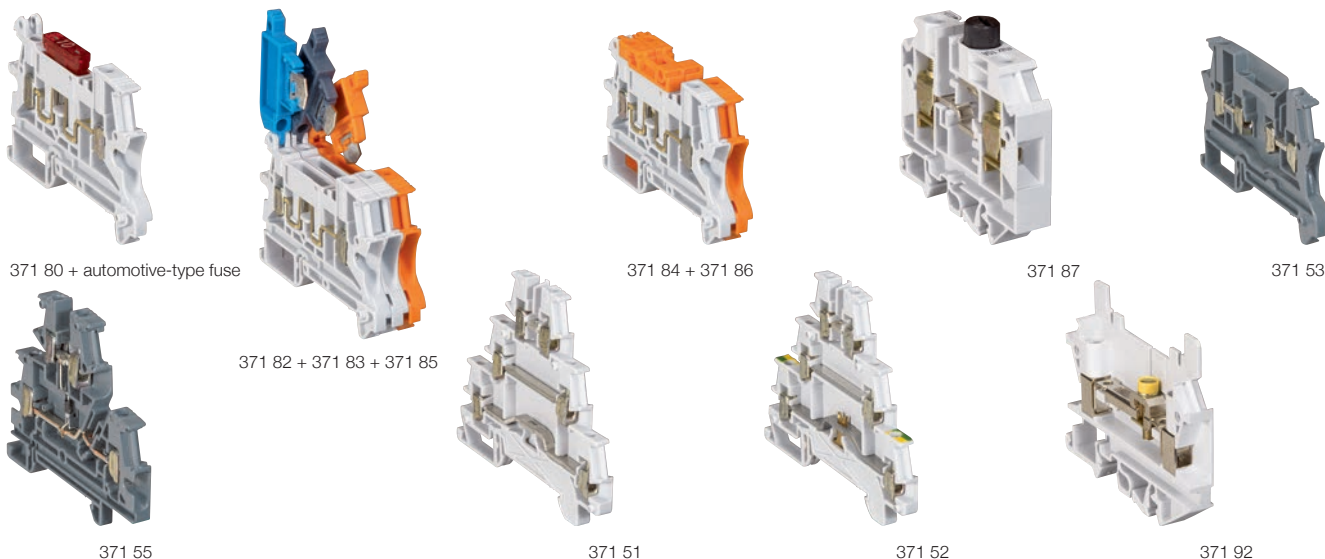

Technical characteristics (p. 169)
Approvals (p. 169)

Used to make the electrical connection between 2 rigid or flexible copper wires
2 areas for bridging combs for alternating equipotential connection up to 8 pitch
For rails \sqcup depth 15 mm, \sqcup EN 60715 depth 7.5 mm and 15 mm

Pack Cat. No. Disconnect terminal blocks 1 connection

Pack	Cat. No.	Disconnect terminal blocks 1 connection				
		Colour	Nominal cross-section (mm ²)	Rigid wire (mm ²)	Flexible wire (mm ²)	Pitch (mm)
20	371 80	Grey	2.5	0.25 to 2.5	0.25 to 2.5	6
20	371 81	Grey	2.5	0.25 to 2.5	0.25 to 2.5	6
20	371 82	Grey/blue	2.5	0.25 to 2.5	0.25 to 2.5	6
20	371 83	Grey	2.5	0.25 to 2.5	0.25 to 2.5	6
20	371 84	Grey	2.5	0.25 to 2.5	0.25 to 2.5	6
20	371 85	Orange	2.5	0.25 to 2.5	0.25 to 2.5	6
20	371 86	Orange	2.5	0.25 to 2.5	0.25 to 2.5	6
20	371 87	Grey	10	0.25 to 16	0.25 to 10	12
20	371 88	Grey	10	0.25 to 16	0.25 to 10	12

Blade type levers, joining rods and blown fuse indicators (p. 167)

New Starfix crimping tools (p. 178)

Pack Cat. No. Function blocks

Pack	Cat. No.	Function blocks				
		Colour	Nominal cross-section (mm ²)	Rigid wire (mm ²)	Flexible wire (mm ²)	Pitch (mm)
20	371 53	Grey	2.5	0.25 to 4	0.25 to 2.5	5
20	371 54	Grey	2.5	0.25 to 4	0.25 to 2.5	5
60	371 55	Grey	4	0.25 to 6	0.25 to 4	6
60	371 56	Grey	4	0.25 to 6	0.25 to 4	6

1 connection - modular

Component connected with screws

Colour	Nominal cross-section (mm ²)	Rigid wire (mm ²)	Flexible wire (mm ²)	Pitch (mm)
Grey	2.5	0.25 to 4	0.25 to 2.5	5

1 connection - diode carrier

Colour	Nominal cross-section (mm ²)	Rigid wire (mm ²)	Flexible wire (mm ²)	Pitch (mm)
Grey	2.5	0.25 to 4	0.25 to 2.5	5

2 connections on 2 levels - diode carrier

Colour	Nominal cross-section (mm ²)	Rigid wire (mm ²)	Flexible wire (mm ²)	Pitch (mm)
Grey	4	0.25 to 6	0.25 to 4	6

2 connections on 2 levels - with LED

Voltage presence indicator (12/24V_{ac} and ~)

Colour	Nominal cross-section (mm ²)	Rigid wire (mm ²)	Flexible wire (mm ²)	Pitch (mm)
Grey	4	0.25 to 6	0.25 to 4	6

For sensors and actuators



For connecting sensors (Cat. No. 371 51) or actuators (Cat.No. 371 52), and their shared power supply unit using equipotential bridging comb Cat. No. 375 46/47 (wiring principle p. 169)

3 connections on 3 levels - for sensor

Colour	Nominal cross-section (mm ²)	Capacity		Pitch (mm)
		Rigid wire (mm ²)	Flexible wire (mm ²)	
Grey	2.5	0.25 to 4	0.25 to 2.5	5

3 connections on 3 levels - for actuator

Green/yellow marking for the lower level
Metal base. Screwless fixing on rail

Colour	Nominal cross-section (mm ²)	Rigid wire (mm ²)	Flexible wire (mm ²)	Pitch (mm)
Grey	2.5	0.25 to 4	0.25 to 2.5	5

Disconnect for measurement

1 connection

With its accessories, allows intervention (measurements, maintenance, etc) on a current, voltage and power measuring circuit by keeping the current transformer secondary circuit closed

Colour	Nominal cross-section (mm ²)	Capacity		Pitch (mm)
		Rigid wire (mm ²)	Flexible wire (mm ²)	
Grey	4	0.25 to 4	0.25 to 4	8

Accessories (p. 166 - 167)

(1) Rigid wire capacity: 2.5 mm² max with equipotential bridging comb



Accessories (p. 166)

Viking™ 3 terminal blocks with spring connection



372 60 + 372 00 + 372 20



372 01



372 21



372 63



372 40

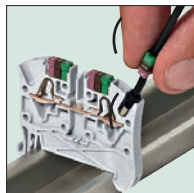

Automatic insertion of flexible wire with ferrule cap or rigid wire up to pitch of 6 mm

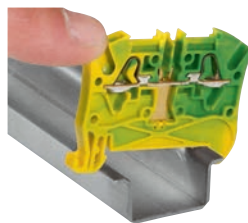

372 70
Automatic fixing on rail



372 79

Technical characteristics (p. 170)

Screwless connection system, stainless steel spring type
Used to make the electrical connection between 2 rigid copper wires, or flexible copper wires with or without ferrules (p. 178)
Direct tool-free insertion of a rigid wire or flexible wire with ferrule, up to 6 mm pitch
2 areas for bridging combs for alternating equipotential connection
For rails \perp depth 15 mm, \perp EN 60715 depth 7.5 mm and 15 mm

Pack	Cat. No.	Connecting					
		Grey for standard circuit, blue for neutral conductor, orange for circuit not broken by the master isolating device					
		1 connection - 2 wires - 1 entry/1 outlet					
			Nominal cross-section (mm ²)	Rigid wire (mm ²)	Flexible wire (mm ²)	Flexible wire with ferrule (mm ²)	Pitch (mm)
60	372 60	Grey	4	0.5 to 6	0.5 to 4	0.5 to 2.5	5
60	372 00	Blue					
60	372 20	Orange					
50	372 61 ⁽¹⁾	Grey					
50	372 01 ⁽¹⁾	Blue	4	0.5 to 6	0.5 to 4	0.5 to 4	6
50	372 21 ⁽¹⁾	Orange					
50	372 62 ⁽¹⁾	Grey					
50	372 02 ⁽¹⁾	Blue	6	0.5 to 6	0.5 to 6	0.5 to 6	8
40	372 63 ⁽¹⁾	Grey					
40	372 03 ⁽¹⁾	Blue	10	0.75 to 10	0.75 to 10	0.75 to 10	10
10	372 64 ⁽¹⁾	Grey					
10	372 04 ⁽¹⁾	Blue	16	4 to 16	4 to 16	4 to 16	12
		1 connection - 3 wires - 1 entry/2 outlets					
60	372 40	Grey					
60	372 41	Blue	4	0.5 to 6	0.5 to 4	0.5 to 2.5	5
60	372 42	Orange					
50	372 43 ⁽¹⁾	Grey					
50	372 44 ⁽¹⁾	Blue	4	0.5 to 6	0.5 to 4	0.5 to 4	6
		1 connection - 4 wires - 2 entries/2 outlets					
60	372 46	Grey					
60	372 47	Blue	4	0.5 to 6	0.5 to 4	0.5 to 2.5	5
50	372 69 ⁽¹⁾	Grey					
50	372 09 ⁽¹⁾	Blue	4	0.5 to 6	0.5 to 4	0.5 to 4	6
		2 connections - 4 wires - 2 levels					
60	372 67	Grey					
60	372 07	Blue	4	0.5 to 6	0.5 to 4	0.5 to 2.5	5
50	372 68 ⁽¹⁾	Grey					
50	372 08 ⁽¹⁾	Blue	4	0.5 to 6	0.5 to 4	0.5 to 4	6

Pack	Cat. No.	For protection conductor					
		Metal base Screwless fixing on rail PEN from 10 mm ²					
		1 connection - 2 wires - 1 entry/1 outlet					
			Nominal cross-section (mm ²)	Rigid wire (mm ²)	Flexible wire (mm ²)	Flexible wire with ferrule (mm ²)	Pitch (mm)
60	372 70	Green/ yellow	4	0.5 to 6	0.5 to 4	0.5 to 2.5	5
50	372 71 ⁽¹⁾	Green/ yellow	4	0.5 to 6	0.5 to 4	0.5 to 4	6
25	372 72 ⁽¹⁾	Green/ yellow	6	0.5 to 6	0.5 to 6	0.5 to 6	8
20	372 73 ⁽¹⁾	Green/ yellow	10	0.75 to 10	0.75 to 10	0.75 to 10	10
15	372 74 ⁽¹⁾	Green/ yellow	16	4 to 16	4 to 16	4 to 16	12
		1 connection - 3 wires - 1 entry/2 outlets					
40	372 10	Green/ yellow	4	0.5 to 6	0.5 to 4	0.5 to 2.5	5
30	372 11 ⁽¹⁾	Green/ yellow	4	0.5 to 6	0.5 to 4	0.5 to 4	6
		1 connection - 4 wires - 2 entries/2 outlets					
40	372 12	Green/ yellow	4	0.5 to 6	0.5 to 4	0.5 to 2.5	5
30	372 79 ⁽¹⁾	Green/ yellow	4	0.5 to 6	0.5 to 4	0.5 to 4	6

CAB 3 marking system (p. 180)

Blade type levers, joining rods and blown fuse indicators (p. 167)

(1) Built-in end cap

Viking™ 3 terminal blocks with spring connection (continued)

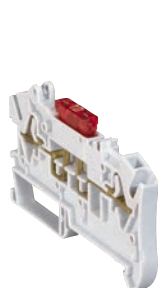

372 80 with automotive-type fuse



372 81 open

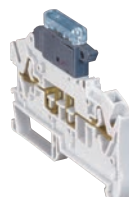

372 81 with blown fuse indicator

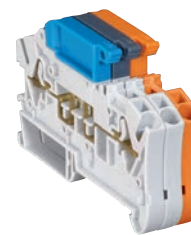

372 82 + 372 83 + 372 85



372 84

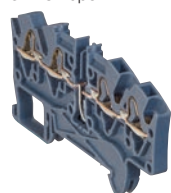

372 54



Technical characteristics (p. 170)

Screwless connection system, stainless steel spring type

Used to make the electrical connection between 2 rigid copper wires, or flexible copper wires with or without ferrules

Direct tool-free insertion of a rigid wire or flexible wire with ferrule, up to 6 mm pitch

2 areas for bridging combs for alternating equipotential connection

For rails \perp depth 15 mm, \perp EN 60715 depth 7.5 mm and 15 mm

Pack	Cat. No.	Disconnect terminal blocks 1 connection - 2 wires					
		Disconnection by means of blade type lever, handle lever or mini lever (with tool)					
		Open (to be equipped)					
		Can take a blade-type automotive fuse or a miniature circuit-breaker or blade type levers Cat. No. 375 15/16/17/18					
				Capacity			
		Colour	Nominal cross-section (mm ²)	Rigid wire (mm ²)	Flexible wire (mm ²)	Flexible wire with ferrule (mm ²)	Pitch (mm)
20	372 80	Grey	2.5	0.5 to 2.5	0.5 to 2.5	0.5 to 2.5	6
		For fuse cartridge 5 x 20 with handle lever					
20	372 81	Grey	2.5	0.5 to 2.5	0.5 to 2.5	0.5 to 2.5	6
		For neutral circuit with blue handle lever					
20	372 82	Grey/blue	2.5	0.5 to 2.5	0.5 to 2.5	0.5 to 2.5	6
		For standard circuit with handle lever					
20	372 83	Grey	2.5	0.5 to 2.5	0.5 to 2.5	0.5 to 2.5	6
		For standard circuit with mini lever					
20	372 84	Grey	2.5	0.5 to 2.5	0.5 to 2.5	0.5 to 2.5	6
		For circuit not broken with handle lever					
		Circuit not broken by the master isolating device					
20	372 85	Orange	2.5	0.5 to 2.5	0.5 to 2.5	0.5 to 2.5	6
		For circuit not broken with mini lever					
		Circuit not broken by the master isolating device					
20	372 86	Orange	2.5	0.5 to 2.5	0.5 to 2.5	0.5 to 2.5	6

Pack	Cat. No.	Function blocks					
		1 connection - 4 wires - 2 entries/2 outlets - diode carrier					
			Nominal cross-section (mm ²)	Rigid wire (mm ²)	Capacity		
		Colour			Flexible wire (mm ²)	Flexible wire with ferrule (mm ²)	Pitch (mm)
60	372 54	Grey	4	0.5 to 6	0.5 to 4	0.5 to 2.5	5
		2 connections - 4 wires - 2 levels - diode carrier					
60	372 55	Grey	4	0.5 to 6	0.5 to 4	0.5 to 2.5	5
		2 connections - 4 wires - 2 levels - with LED					
		Voltage presence indicator (12/24V _~ et \sim)					
60	372 56	Grey	4	0.5 to 6	0.5 to 4	0.5 to 2.5	5

Accessories (p. 166 - 167)

New Starfix crimping tools (p. 178)



Accessories (p. 166)



Starfix crimping tools (p. 178)

Accessories for Viking™ 3 terminal blocks

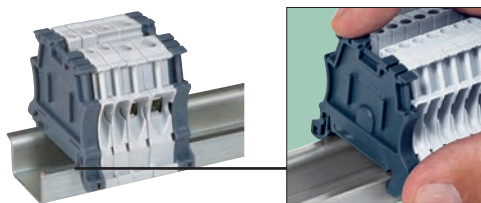

End stop 375 10, screwless mounting



375 11 with label holder 395 96

375 12 with CAB 3 labelling

CAB 3 markers

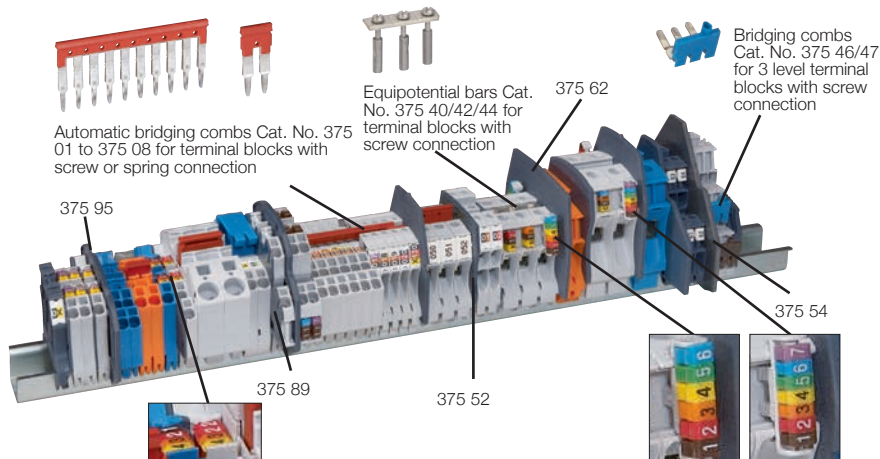

Automatic bridging combs Cat. No. 375 01 to 375 08 for terminal blocks with screw or spring connection

Equipotential bars Cat. No. 375 40/42/44 for terminal blocks with screw connection

Bridging combs Cat. No. 375 46/47 for 3 level terminal blocks with screw connection

375 95

375 62

375 54

375 89

375 52



CAB 3 label holders Cat. No. 383 92 for terminal blocks with screw connection

Technical characteristics (p. 171)

Pack Cat. No. Rails for cutting to length

Pack	Cat. No.	Length
10	374 02	2 metres
10	374 04	G32 Section EN 60715
10	374 07	↳ EN 60715 depth 7.5 mm
10	477 22	↳ depth 15 mm
10	477 22	↳ depth 7.5 mm with oblong holes

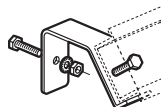

10 394 49 45° mounting bracket

Set of 2 supports for tilting a rail at an angle of 45°
Supplied with 4 x M6 screws, nuts and washers

End stops

Accept CAB 3 markers

Automatic 6 mm pitch

Screwless mounting
For rails ↳ depth 15 mm and ↳ EN 60715 depth 7.5 mm and 15 mm
Accepts label holder Cat. No. 395 96
Acts as end cap for screw terminal blocks 1 entry/1 outlet 5, 6, 8 and 10 mm pitch

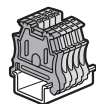

8 mm pitch

For rails ↳ depth 15 mm and ↳ EN 60715 depth 7.5 mm and 15 mm
Accepts label holder Cat. No. 395 96

10 mm pitch

For rails ↳ depth 15 mm and ↳ EN 60715 depth 7.5 mm (except for rail fixed on plate) and 15 mm
For supporting protection or shielding bar:
- Brass bar Cat. No. 373 00/01
- Copper bar 12 x 4 mm with clamps Cat. No. 373 02
- IP 2X terminal block with flat steel bar 12 x 2 mm Cat. No. 048 19
- Copper bar 12 x 4 mm Cat. No. 373 49 or 373 89
- Shielding bar 10 x 3 mm Cat. No. 375 34

12 mm pitch

For rails ↳ EN 60715, ↳ depth 15 mm and ↳ EN 60715 depth 7.5 mm and 15 mm
After cutting out the upper divider, can be labelled using Duplix label holder Cat. No. 384 98

Identification accessories

20	395 96	Transparent label holder with variable angle Fixing on end stops Cat. No. 375 10/11 Supplied with label 32 x 9.5 mm Can take label Cat. No. 395 97
20	395 97	Label for engraving 28 x 9.5 mm For label holder Cat. No. 395 96. Flexible ABS White background, black engraving
10	395 98	Black felt tip pen for permanent marking



Pack Cat. No. End caps

		Grey
		For screw terminal blocks
100	375 50	1 entry/1 outlet 5, 6, 8 and 10 mm pitch
20	375 51	1 entry/1 outlet 12 and 15 mm pitch
20	375 52	2 entries/2 outlets
20	375 53	2 levels
20	375 54	3 levels
20	375 55	Disconnect type 6 mm pitch and function blocks 5 mm pitch
20	375 56	Disconnect type fuse cartridge 5 x 20 and 6.3 x 32 with screwed plug
10	375 57	Disconnect for measurement
		For spring terminal blocks with 5 mm pitch
		Allows the block to become 6 mm pitch and take a flexible wire fitted with a ferrule 4 mm ²
50	375 86	1 entry/1 outlet
50	375 87	1 entry/2 outlets
20	375 88	2 entries/2 outlets
20	375 89	2 levels
		For spring terminal blocks with 6 mm pitch
20	375 90	Disconnect type

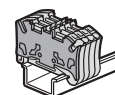
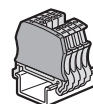

Separation and insulation dividers

		Grey
		For screw terminal blocks
20	375 60	1 entry/1 outlet 5, 6, 8 and 10 mm pitch
10	375 61	1 entry/1 outlet 12 and 15 mm pitch
10	375 62	2 entries/2 outlets and disconnect type 6 mm pitch
10	375 63	2 levels
20	375 54	3 levels
		For spring terminal blocks
10	375 95	1 entry/1 outlet, 1 entry/2 outlets and 2 entries/2 outlets 5 and 6 mm pitch
10	375 96	2 levels

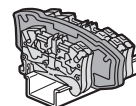
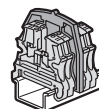

Equipotential bridging accessories

		Bridging combs for screw and spring terminal blocks
		Front mounting (automatic insertion), screwless Isolated and separable. Consecutive or alternating connection. Red
20	375 01 ⁽¹⁾	For 10 blocks with 5 mm pitch
50	375 02 ⁽¹⁾	For 2 blocks with 5 mm pitch
20	375 04 ⁽²⁾	For 10 blocks with 6 mm pitch
50	375 05 ⁽²⁾	For 2 blocks with 6 mm pitch
20	375 07 ⁽³⁾	For 3 blocks with 8 mm pitch
20	375 08 ⁽³⁾	For 2 blocks with 8 mm pitch

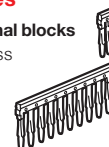

(2) Block Cat. No. 371 56: lower level only
(3) Except for Cat. No. 371 92

Accessories for Viking™ 3 terminal blocks (continued)

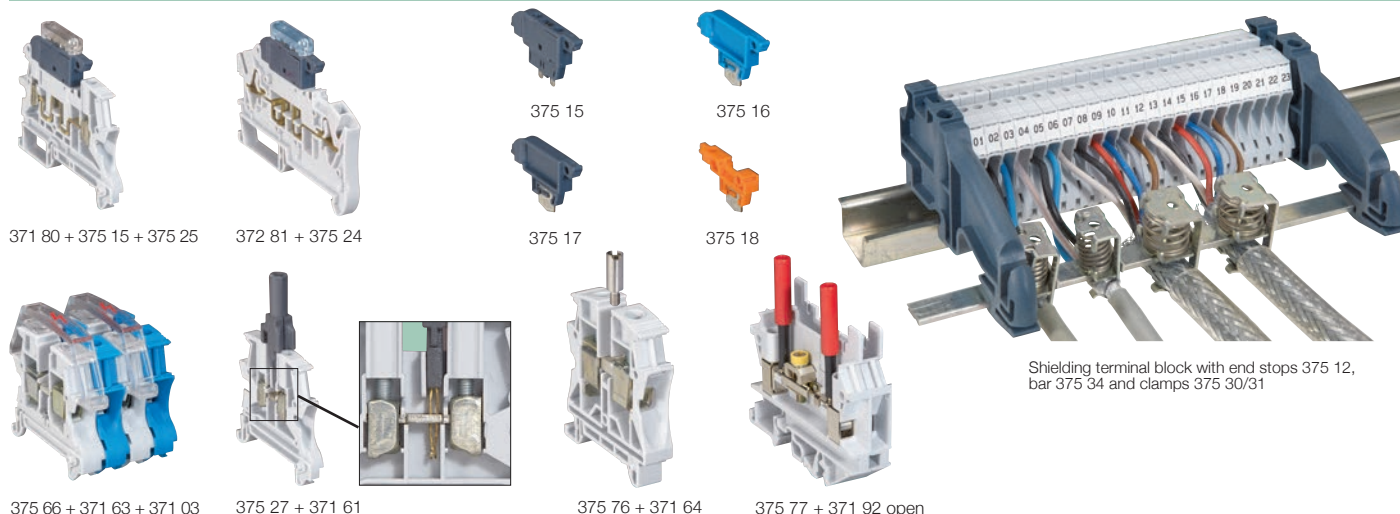

Shielding terminal block with end stops 375 12, bar 375 34 and clamps 375 30/31

375 66 + 371 63 + 371 03 375 27 + 371 61

375 76 + 371 64 375 77 + 371 92 open

Technical characteristics (p. 171)

Pack Cat. No. Equipotential bridging accessories (continued)

Pack	Cat. No.	Equipotential bridging accessories (continued)
		Bars for screw terminal blocks
		Front mounting with screws. Pre-assembled, bar Consecutive or alternating connection
10	375 40	For 12 blocks with 10 mm pitch
10	375 42 ⁽¹⁾	For 12 blocks with 12 mm pitch
10	375 44	For 12 blocks with 15 mm pitch
		Bridging combs for 3-level screw terminal blocks
		For lower and intermediate levels of blocks Cat. No. 371 51/52. Side mounting Isolated and separable
10	375 46	Brown. For 12 blocks with 5 mm pitch
10	375 47	Blue. For 12 blocks with 5 mm pitch
		Bridging combs for spring terminal blocks
		Front mounting (automatic insertion), screwless Isolated. Red
20	375 82	For 2 blocks with 10 mm pitch
20	375 85	For 2 blocks with 12 mm pitch

Accessories for disconnect blocks

		For screw and spring terminal blocks
		Blade type levers
		For open blocks Cat. No. 371 80 and 372 80 Manual disconnection for handle type, tool required for mini lever type
10/50	375 15	With handle lever for fuse cartridge 5 x 20
10/50	375 16	Blue handle lever for neutral
10/50	375 17	Grey handle lever
10/50	375 18	Mini lever
		Joining rods
		For handle and mini lever
20	375 21	For 2 blocks
20	375 22	For 3 blocks
		Blown fuse indicators
		Clip directly onto blocks Cat. No. 371 81, 372 81 or handle lever 375 15 (with power off)
10/50	375 24	12/24/48 V _~ and - for block with fuse cartridge 5 x 20 with handle lever
10/50	375 25	110/250 V _~ for block with fuse cartridge 5 x 20 with handle lever

Shielding accessories

		Ensure safe, simple connection of cable shielding
		Shielding clamps
		For screw and spring terminal blocks - mounted by pivoting on collector bar 10 x 3 mm Cat. No. 375 34 - mounted on plate with M4 screws (supplied) - mounted on rail with Cat. No. 364 69
10	375 30	For cable diam. 3 to 8 mm
10	375 31	For cable diam. 4 to 13.5 mm
4	375 32	For cable diam. 10 to 20 mm

Pack Cat. No. Shielding accessories (continued)

		Ensure safe, simple connection of cable shielding
		Shielding bar
		For screw and spring terminal blocks. Steel. Length 1 m. For use with end stops Cat. No. 375 12
10	375 34	10 x 3 mm
		Screening continuity bracket
		For screw terminal blocks 1 entry/1 outlet 5, 6, 8 and 10 mm pitch Connected with 2.8 x 0.8 mm clips or welded on. Capacity: 1 mm ²
50	375 35	
		Protective screens
		1 pole
		For screw terminal blocks 1 entry/1 outlet
10	375 65	5 and 6 mm pitch
10	375 66	8 and 10 mm pitch
10	375 67	12 and 15 mm pitch
		Cut to length
		Length 1 m Mounted on separation and insulation divider For screw terminal blocks 1 entry/1 outlet
10	375 68	5, 6, 8 and 10 mm pitch (divider Cat. No. 375 60)
10	375 69	12 and 15 mm pitch (divider Cat. No. 375 61)
		Measurement accessories
		For screw and spring terminal blocks
		Measurement socket for Ø4 mm plug for blocks with 5 and 6 mm pitch
10	375 27 ⁽²⁾	
		For screw terminal blocks
		Measurement socket for Ø2 mm plug for blocks with 10 mm pitch Cat. No. 371 03/63
50	375 75	
		Measurement socket for Ø4 mm plug for blocks with 12 and 15 mm pitch Cat. No. 371 04/05/64/65
20	375 76	
		Measurement socket for Ø4 mm plug for disconnect block for measurement Cat. No. 371 92
10	375 77	
		IP 2X safety tip adaptor
		Ø2 mm test plug - Retractable tube For performing ad-hoc tests in accordance with regulations on the protection of workers Fixes directly on the 4 mm plug
1/10	394 45	

(1) Except for Cat. No. 371 87

(2) Except for disconnect blocks with handle lever, screw terminal block with LED and spring function blocks. 2 and 3-level terminal blocks: upper level only

Viking™ 3 terminal blocks with screw connection

Characteristics and dimensions (mm)

V2 polyamide according to UL 94, 960° C according to IEC EN 60695-2-11

Connecting blocks

Cat. No.	Voltage (V)			Current (A)				Nominal cross-section		
	IEC	CSA	UL	1e	IEC	CSA	UL	IEC (mm²)	CSA (AWG)	UL (AWG)
371 00/20/30/60	800	600	600	27	24	20	20	2.5	12	12
371 01/21/31/61				36	32	30	30	4	10	10
371 02/62				48	41	50	50	6	8	8
371 03/63				63	57	60	60	10	6	6
371 04/64				85	76	85	85	16	4	4
371 05/65				138	125	115	115	35	2	2
371 07/67				27	24	20	20	2.5	12	12
371 08/68	500	300	300	36	32	30	30	4	10	10
371 09/69				36	32	30	30	4	10	10
371 66				213	192	200	200	70	000	000
371 77	800	600	600	36	32	30	30	4	10	10
371 78				48	41	50	50	6	8	8

Cat. No. 371 51: see blocks for sensors
IEC 60947-7-1, CSA no. 22-2 no. 158, UL 1059
le: Rated current NF C 15100 table 52H, column 4

Cat. No. 371 00/01/02/03
/20/21/30/31/60/61/62/6
3/77/78

Cat. No. 371 04/05/64/65

Cat. No. 371 66

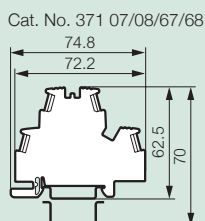
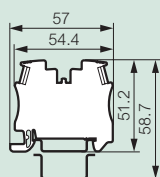
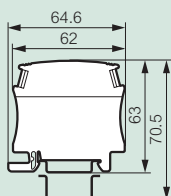
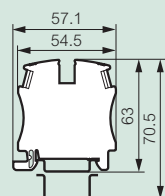
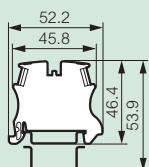

Blocks for protection conductor

Cat. No.	Voltage (V)			Current (A)			Nominal cross-section		
	IEC	CSA	UL	1e	IEC	UL	IEC (mm²)	CSA (AWG)	UL (AWG)
371 70	800	600	600	-	-	-	2.5	12	12
371 71				-	-	-	4	10	10
371 72				-	-	-	6	8	8
371 73⁽¹⁾				63	57	60	10	6	6
371 74⁽¹⁾				85	76	85	16	4	4
371 75⁽¹⁾				138	125	115	35	2	2
371 76				-	-	-	-	-	-
371 77	800	600	600	36	32	30	4	10	10
371 78				48	41	50	6	8	8
371 79	500	300	300	-	-	-	4	10	10

IEC 60947-7-1/7-2, CSA no. 22-2 no. 158, UL 1059
le: Rated current NF C 15100 table 52H, column 4
(1) PEN terminal blocks

Cat. No. 371 70/71/72/73

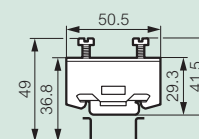
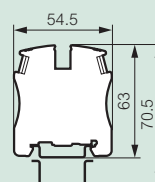
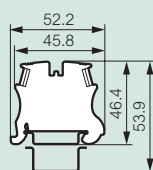

Cat. No. 371 77/78

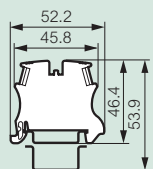

Cat. No. 371 79

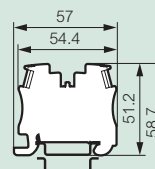

Disconnect terminal blocks

Cat. No.	Voltage (V)			Current (A)			Nominal cross-section		
	IEC	CSA	UL	IEC	CSA	UL	IEC (mm²)	CSA (AWG)	UL (AWG)
371 80	500	300	300	15	15	15	2.5	12	12
371 81 ou 371 80 + 375 15	250	250	250	6.3	6.3	6.3			
371 82	500	300	300	15	15	15			
371 83									
371 84									
371 85									
371 86	250	250	250	10	10	10			
371 87/88									

IEC 60947-7-1/7-3, CSA no. 22-2 no. 158, UL 1059

Power according to EN 60947-7-3

Cat. No.	Short-circuit		Short-circuit + overload	
	Separate blocks	Assembled blocks	Separate blocks	Assembled blocks
371 81 or 371 80 + 375 15⁽¹⁾	4 W / 6.3 A	1.6 W/6.3 A	1.6 W/6.3 A	-
	Pvk = 4.75 W	Pvk = 2 W	Pv = 1.65 W	-
371 87/88	4 W	2.5 W	1.6 W	-
	Pvk = 5 W	Pvk = 2.7 W	Pv = 1.8 W	-

(1): With or without blown fuse indicator Cat. No. 375 25

Cat. No. 371 80

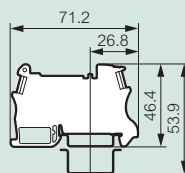

Cat. No. 371 81/82/83/85

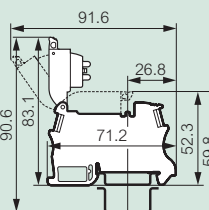

Cat. No. 371 84/86

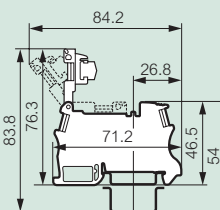

Cat. No. 371 87/88

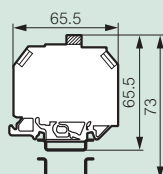

Approved by ATEX: LCIE 07 ATEX 0010 U-0081 Ex II 1 or 2 G or D Ex e/i/tD/iD II

The terminal blocks with screw connection covered by this certificate are 1-, 2- and 3-level connecting terminal blocks, and blocks for protection conductor with metal⁽¹⁾ and plastic base.

The main characteristics are:
Operating temperature: - 30° C to + 55° C
Maximum temperature of materials: + 85° C

Working voltage acc. to EN 60079-7:

1-level terminal blocks: 500 V
Blocks with 2 entries - 2 outlets: 250 V
2 and 3-level terminal blocks: 250 V

Rated current:

Conductor cross-section (mm²)	2.5	4	6	10	16	35	70
Rated current (A)	18	23	30	42	57	93	144

Attestation of conformity of component for the customer is available on request

(1) Except for Cat. No. 371 76

Function blocks

Cat. No.	Voltage (V)			Current (A)			Nominal cross-section		
	IEC	CSA	UL	IEC	CSA	UL	IEC (mm ²)	CSA (AWG)	UL (AWG)
371 53	250	-	-	-	-	-	2,5	-	-
371 54	250	-	-	1	-	-	2,5	-	-
371 55	500	300	300	1	1	1	4	10	10
371 56	12 to 24	12 to 24	12 to 24	32	30	30	4	10	10

IEC 60947-7-1, CSA no. 22-2 no. 158, UL 1059

Cat. No. 371 53/54

Cat. No. 371 55/56

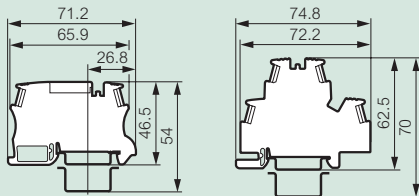

Schematic diagrams

Cat. No. 371 53

Cat. No. 371 54

Cat. No. 371 55

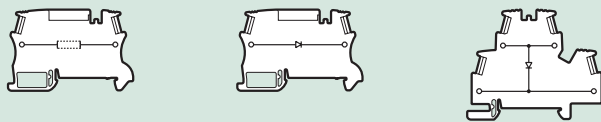

Cat. No. 371 56

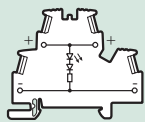

Diode for Cat. No. 371 54/55
 - 1N4007 type 1A
 - direct current = 1 A
 - peak inverse voltage 1000 V
 - inverse current 5 µA at 25° C

Blocks for sensors and actuators/PNE

Cat. No.	Voltage (V)			Current (A)			Nominal cross-section			
	IEC	CSA	UL	I _e	IEC	CSA	UL	IEC (mm ²)	CSA (AWG)	UL (AWG)
371 51	400	300	300	27	24	20	20	2,5	12	12
371 52										

IEC 60947-7-1/7-2, CSA no. 22-2 no. 158, UL 1059
 I_e: Rated current NF C 15100 table 52H, column 4

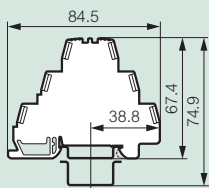

Wiring principle

Block for sensor Cat. No. 371 51

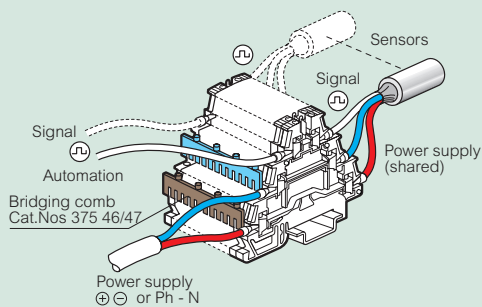

Block for actuator Cat. No. 371 52

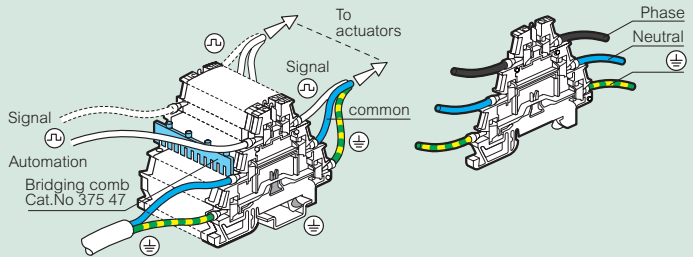

Disconnect block for measurement

Cat. No.	Voltage (V)			Current (A)			Nominal cross-section		
	IEC	CSA	UL	IEC	CSA	UL	IEC (mm ²)	CSA (AWG)	UL (AWG)
371 92	800	-	-	24	-	-	4	-	-

IEC EN 60947-7-1

Cat. No. 371 92

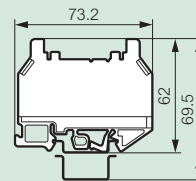

Wiring principle for measurement blocks Cat. No. 371 92

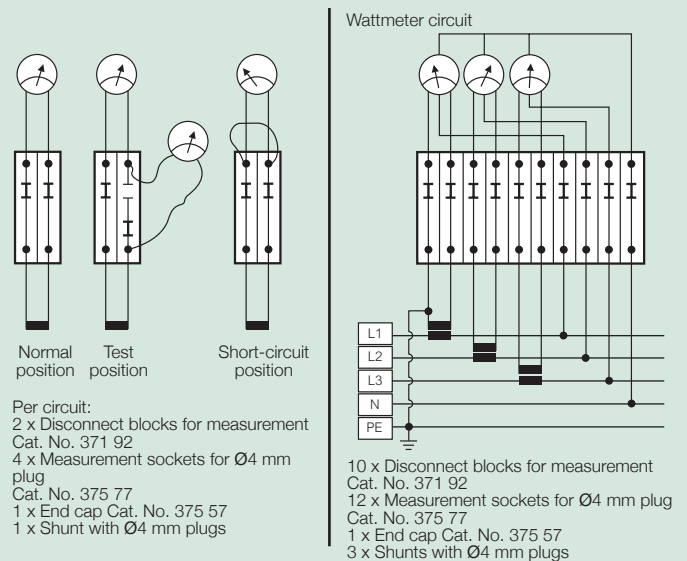

Stripped lengths (mm)

Screw terminal pitch (mm)	Rigid or flexible wire
5	6 to 8
6	
8	
10	10 to 12
12	13 to 17
15	14 to 18
22	15 to 22

Protection against fire and panic risks in public buildings/UTE C 12-201 guide

Art. EL 3, definitions: "Security installations are those that have to be put into or maintained in service to ensure the evacuation of the public or facilitate the intervention of the first-aid"

Art. EL 16, power supply circuits in security installations section 1a: "...the corresponding junction or deviation devices and their enclosures, except for the waterproofing systems, must satisfy the incandescent wire test defined in the standard in force, the temperature of the incandescent wire being 960° C"
 Viking 3 terminal blocks satisfy the incandescent wire test 960° C according to standard IEC 60695-2-11

Viking™ 3 terminal blocks with spring connection

Characteristics and dimensions (mm)

V2 polyamide according to UL 94, 960° C according to IEC EN 60695-2-11

Connecting blocks

Cat. No.	Voltage (V)			Current (A)			Nominal cross-section			
	IEC	CSA	UL	IE	IEC	CSA	UL	IEC (mm²)	CSA (AWG)	UL (AWG)
372 00	800	600	600	36	32	20	20	4	12	12
372 01				48	41	30	30	6	10	10
372 02				63	57	50	50	10	8	8
372 03				85	76	65	65	16	6	6
372 04	800	600	600	36	32	20	20	4	12	12
372 07										
372 08										
372 09										
372 20										
372 21										
372 40										
372 41										
372 42										
372 43										
372 44										
372 46										
372 47										
372 60										
372 61										
372 62										
372 63	63	57	50	50	10	8	8			
372 64	85	76	65	65	16	6	6			
372 67	500	300	300	36	32	30	30	4	10	10
372 68	800	600	600	36	32	20	20	4	12	12
372 69										

IEC 60947-7-1, CSA no. 22-2 no. 158, UL 1059
 Ie: Rated current NF C 15100 table 52H, column 4

Blocks for protection conductor

Cat. No.	Voltage (V)			Nominal cross-section		
	IEC	CSA	UL	IEC (mm²)	CSA (AWG)	UL (AWG)
372 10	800	600	600	4	10	10
372 11						
372 12						
372 70						
372 71						
372 72						
372 73 ⁽¹⁾						
372 74 ⁽¹⁾						
372 75						
372 79						

Function blocks

Cat. No.	Voltage (V)			Current (A)			Nominal cross-section		
	IEC	CSA	UL	IEC	CSA	UL	IEC (mm²)	CSA (AWG)	UL (AWG)
372 54	500	300	300	1	1	1	4	14	14
372 55									
372 56									

IEC 60947-7-1, CSA no. 22-2 no. 158, UL 1059

Cat. No. 372 00/01/20/
21/60/61/70/71

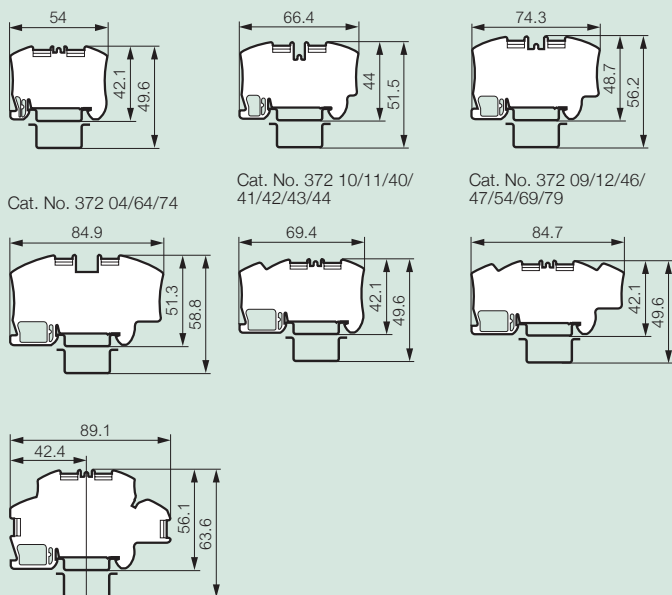

Schematic diagrams

Cat. No. 372 54

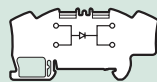

Cat. No. 372 55

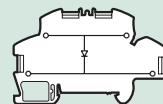

Cat. No. 372 56

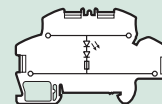

Diode for Cat. No. 372 54/55
 - 1N4007 type 1A
 - direct current = 1 A
 - peak inverse voltage 1000 V
 - inverse current 5 µA at 25° C

Approved by ATEX:

LCIE 07 ATEX 0010 U-0081 II 1 or 2 G or D Ex e/i/ID/II

The terminal blocks with spring connection covered by this certificate are 1- and 2-level connecting terminal blocks, and blocks for protection conductor with metal base.

The main characteristics are:

Operating temperature: - 30° C to + 55° C

Maximum temperature of materials: + 85° C

Working voltage acc. to EN 60079-7:

1-level terminal blocks: 500 V
 Blocks with 2 entries - 2 outlets: 500 V
 2-level terminal blocks: 250 V

Rated current:

Conductor cross-section (mm²)	4	6	10	16
Rated current (A)	23	30	42	57

Attestation of conformity of component for the customer is available on request

Disconnect blocks

Cat. No.	Voltage (V)			Current (A)			Nominal cross-section		
	IEC	CSA	UL	IEC	CSA	UL	IEC (mm²)	CSA (AWG)	UL (AWG)
372 80	500	300	300	15	15	15	2.5	14	14
372 81 or 372 80 + 375 15	250	250	250	6.3	6.3	6.3			
372 82	500	300	300	15	15	15			
372 83									
372 84									
372 85									
372 86									

IEC 60947-7-1/7-3, CSA no. 22-2 no. 158, UL 1059

Power according to EN 60947-7-3

Cat. No.	Short-circuit		Short-circuit + overload	
	Separate blocks	Assembled blocks	Separate blocks	Assembled blocks
372 81 ou 372 80 + 375 15 ⁽¹⁾	4 W / 6.3 A	1.6 W / 6.3 A	1.6 W / 6.3 A	-
	Pvk = 4.75 W	Pvk = 2 W	Pv = 1.65 W	-

(1): With or without blown fuse indicator Cat. No. 375 25

Cat. No. 372 80

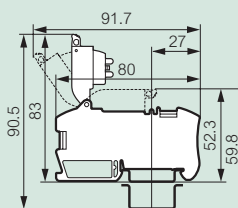
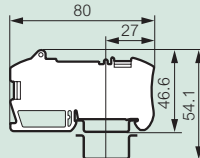

Cat. No. 372 84/86

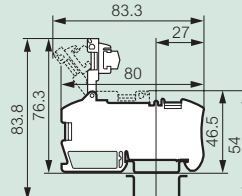

Viking™ 3 terminal blocks with spring connection

Accessories for Viking™ 3 terminal blocks

Stripped lengths (mm)

Spring terminal pitch (mm)	Rigid or flexible wire
5	
6	8 to 12
8	
10	8 to 13
12	8 to 15

Protection against fire and panic risks in public buildings/UTE C 12-201 guide

Art. EL 3, definitions: "Security installations are those that have to be put into or maintained in service to ensure the evacuation of the public or facilitate the intervention of the first-aid"

Art. EL 16, power supply circuits in security installations section 1a: "...the corresponding junction or deviation devices and their enclosures, except for the waterproofing systems, must satisfy the incandescent wire test defined in the standard in force, the temperature of the incandescent wire being 960° C"

terminal blocks satisfy the incandescent wire test 960° C according to standard IEC 60695-2-11

■ Characteristics and dimensions (mm)

End stops

Cat. No. 375 10

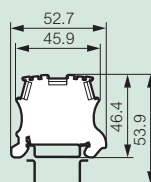

Cat. No. 375 11

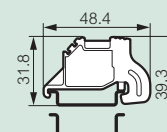

Cat. No. 375 12

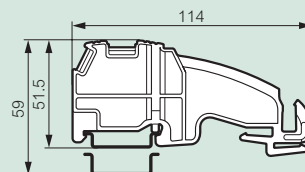

Cat. No. 375 13

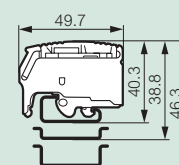

End caps

Cat. No.	Thickness (mm)
375 50	2
375 51	2.5
375 52	2
375 53	2
375 54	2.5
375 55	2
375 56	1.4
375 57	1.4
375 86	1
375 87	1.1
375 88	1.1
375 89	1.1
375 90	2

Separation and insulation dividers

Cat. No.	Thickness (mm)
375 54	2.5
375 60	2.5
375 61	2.6
375 62	2.5
375 63	2.5
375 95	2.8
375 96	2.7

Equipotential bridging combs/bars

Cat. No.	Cross-section (mm²)
375 01	2.5
375 02	2.5
375 04	4
375 05	4
375 07	6
375 08	6
375 40	10
375 42	16
375 44	35
375 46	2.5
375 47	2.5
375 82	10
375 85	16

Shielding clamps

Mounting on bar
10 x 3 Cat. No. 375 34

Mounting on plate

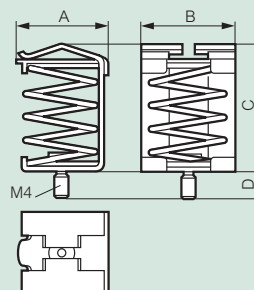
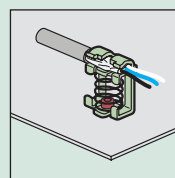
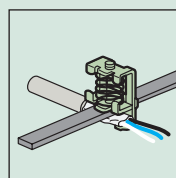

Cat. No.	A	B	C	D
375 30	13.5	18	26	5.6
375 31	20	20.3	31.4	5.3
375 32	24.8	26	40	5.3

Viking™ 3 power terminal blocks

 Approvals (p. 50)	ELECTRICAL FUNCTION		TERMINAL BLOCKS				INSULATION Separation and insulation divider	EQUIPOTENTIAL LINK Shunt	PROTECTION		ASSOCIATED PRODUCTS CAB 3 (p. 180)
			Max. connection (mm ²)	Pitch (mm)	Cat. No.				Cover 4 blocks	Cover 3 blocks	
		Rail			Rail						
390 11 390 21 390 14 Power terminal blocks (p. 173)	Cable - cable			42	390 10	•		394 46			
				55	390 11	•		394 47			
	Cable lug - Cable lug			36	390 13	•		394 46			
				42	390 14	•		394 46			
				55	390 15	•		394 47			
	Cable lug - Cable			42	390 17	•		394 46			
				55	390 18	•		394 47			
	Cable - Cable lug			42	390 20	•		394 46			
				55	390 21	•		394 47			

Some items sold separately

For pack quantity, please refer to numerical index pages

For trade price, please see your local HPM Legrand representative for the current price list

Viking™ 3 power terminal blocks

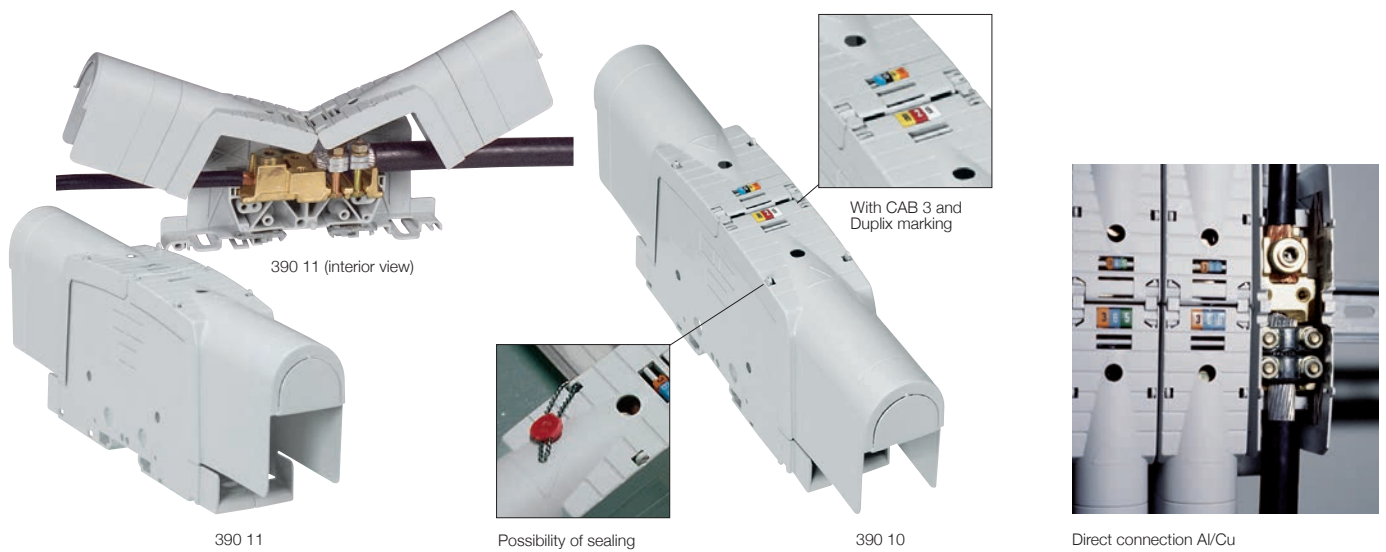

Pack	Cat. No.	For copper and aluminium cables		
		Bridging the gap between the enclosure and external cables Fixed using metal clip for rails ≥ 15 mm depth and \geq EN 60715 15 mm depth, or on plate with screws Fitted with covers with cut-outs Permits the use of Cab 3, Duplix markers Test via test plug $\varnothing 4$ closed covers Blocks with identical pitch can be joined using a threaded rod Supports shunt with Cat. No. 394 46/47		
5	390 10	Cable/cable Rigid or flexible connecting cable (mm ²)	Rigid or flexible connecting cable (mm ²)	Pitch (mm)
5	390 11	Al/Cu 35 to 120 Al/Cu 70 to 300	Cu 35 to 70 Cu 70 to 150	42 55
		Cable lug/cable lug Connecting plate max. (mm ²)	Connecting plate max. (mm ²)	Pitch (mm)
5	390 13	Al/Cu 95	Al/Cu 95	36
5	390 14	Al/Cu 150	Al/Cu 150	42
5	390 15	Al/Cu 300	Al/Cu 300	55
		Cable lug/cable Connecting plate max. (mm ²)	Rigid or flexible connecting cable (mm ²)	Pitch (mm)
5	390 17	Al/Cu 150	Cu 35 to 95	42
5	390 18	Al/Cu 300	Cu 70 to 150	55
		Cable/cable lug Rigid or flexible connecting cable (mm ²)	Connecting plate max. (mm ²)	Pitch (mm)
5	390 20	Cu 35 to 120 Al 35 to 120	Al/Cu 120 Al/Cu 70	42
5	390 21	Cu 70 to 300 Al 70 to 300	Al/Cu 300 Al/Cu 150	55

Pack	Cat. No.	Accessories for power terminal blocks for copper and aluminium cables
		Shunt
5	394 46	For blocks with pitch 36 and 42 mm
5	394 47	For blocks with pitch 55 mm

Viking™ 3 power terminal blocks

■ Characteristics of power terminal blocks for copper and aluminium cables

IK 04
 Conform to IEC EN 60947-7-1
 UL 1059 and 486 E - CSA 22-2
 Fire resistant IEC EN 60695-2-11: 960° C (except cover)
 V2 according to UL 94
 Insulation voltage U_i : 1000 V
 Impulse voltage U_{imp} : 12 kV
 Insulating material:
 - polyamide body - 30° C to + 100° C
 - polypropylene cover - 25° C to + 100° C

Connection table

Cat. No.	Connection (mm²)	Width of plate (mm)	Screw Ø	Connection (mm²)	Width of plate (mm)	Screw Ø
Cable - Cable						
390 10	Rigid or flexible Cu/Al: 35 to 120			Rigid or flexible Cu: 35 to 70		
390 11	Rigid or flexible Cu/Al: 70 to 300			Rigid or flexible Cu: 70 to 150		
Cable lug - Cable lug						
390 13	Cu/Al: max. 95	28	M 8	Cu/Al: max. 95	28	M 8
390 14	Cu/Al: max. 150	34	M 10	Cu/Al: max. 150	34	M 10
390 15	Cu/Al: max. 300	46	M 12	Cu/Al: max. 300	46	M 12
Cable lug - Cable						
390 17	Cu/Al: max. 150	34	M 10	Rigid or flexible Cu: 35 to 95		
390 18	Cu/Al: max. 300	46	M 12	Rigid or flexible Cu: 70 to 150		
Cable - Cable lug						
390 20	Rigid or flexible Cu: 35 to 120 Al: 35 to 120			Cu/Al: max. 120 Cu/Al: max. 70	34	M 10
390 21	Rigid or flexible Cu: 70 to 300 Al: 70 to 300			Cu/Al: max. 300 Cu/Al: max. 150	46	M 12

Cable - cable



Terminal for cable lug - terminal for cable lug



Terminal for cable lug - cable



Cable - terminal for cable lug



Currents table

Cat. No.	Current (A)				Short-circuit current (kA)		Tightening torque (Nm)	
	Shunted input		I/O currents		Shunted input	I/O	Site	Factory
	IEC	IEC	CSA	UL				
Cable - Cable								
390 10	340	250	200	175	14.4	8.4	15	15
390 11	570	400	300	285	36	18	35	35
Cable lug - Cable lug								
390 13	310	310	250	230	11.4	11.4	15	15
390 14	415	415	340	285	18	18	15	15
390 15	670	670	520	420	36	36	35	35
Cable lug - Cable								
390 17	415	315	210	230	18	11.4	15	15
390 18	670	420	325	285	36	18	35	35
Cable - Cable lug								
390 20	340	340	235	255	14.4	8.4	15	15
390 21	570	570	375	420	36	18	35	35
Shunts								
394 46	450 max.							6
394 47	700 max.							10

Cable section equivalence table

mm²	35	70	95	120	150	185	300
AWG	2	00	0000	250	300	350	600

Dimensions (mm)

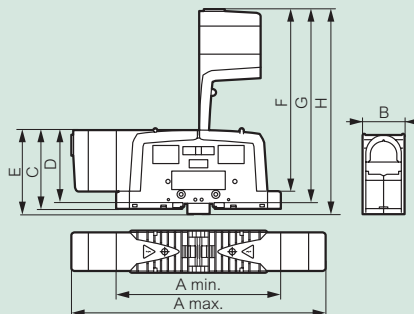

Cat. No.	A max.	A min.	B	C	D	E	F	G	H
390 13	227	155	36	82	73	88	176	185	191
390 10/14/17/20	296	200	42	83.5	74.5	89.5	212	221	227
390 11/15/18/21	337	216	55	107.3	98.5	113.5	257	266	272

■ Separation barriers

Dimensions (mm)

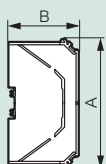

Cat. No.	A	B	Th.
394 77	106	82	8
394 78	188	102	12

Cat. No. 394 77/78

Marking labels for Viking 3 Terminal blocks

LEGRAND PACKAGING



Practical and eco-friendly

Legrand packaging - your guarantee of a certified original product which is factory inspected, protected and clearly identifiable.

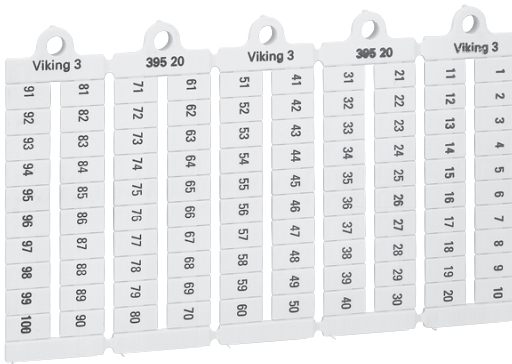

395 20



395 98

Pack	Cat. No.		Marking label sheets
10	395 00		Blank markers 100 snap off markers
10	395 01		For blocks 5mm pitch
10	395 02		For blocks 6mm pitch
			For blocks 8mm pitch
	Horizontal	Vertical	
	Marker width 5 mm		
10	395 05	395 55	From 1 to 10 (10 times)
10	395 06	395 56	From 11 to 20 (10 times)
10	395 07	395 57	From 21 to 30 (10 times)
10	395 08	395 58	From 31 to 40 (10 times)
10	395 09	395 59	From 1 to 50 (2 times)
10	395 10	395 60	From 1 to 100
10	395 11	395 61	From 101 to 200
10	395 12	-	From 201 to 300
	Marker width 6 mm		
10	395 15	395 65	From 1 to 10 (10 times)
10	395 16	395 66	From 11 to 20 (10 times)
10	395 17	395 67	From 21 to 30 (10 times)
10	395 18	395 68	From 31 to 40 (10 times)
10	395 19	395 69	From 1 to 50 (2 times)
10	395 20	395 70	From 1 to 100
10	395 21	395 71	From 101 to 200
10	395 22	-	From 201 to 300
10	395 23	-	From 301 to 400
10	395 24	-	From 401 to 500
	Upper case letters and conventional symbols		
	Horizontal reading format Composition: 12 x L1, 12 x L2, 12 x L3, 14 x T, 10 x PEN, 10 x PE, 10 x P, 20 x N		
	For terminals of pitch (mm): 6		
10	395 36		
	Black felt tip pen		
10	395 98		Indelible for marking



Dustproof flaps:
effective protection
of the product

Resealable box:
for easy management
of the contents

Informative label:
- Catalogue number/quantity
- Picture of the product
- Clear description
- Technical information
- Barcode
- Regulatory marking

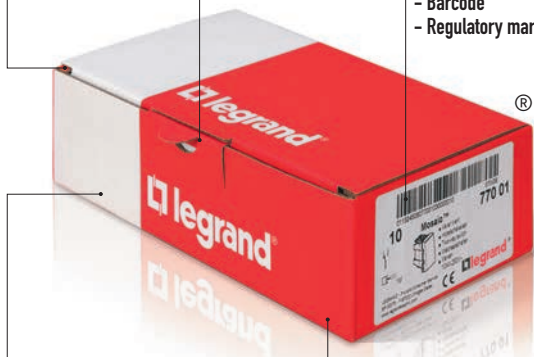

The red and white
box and the logo
are registered
trademarks

Eco-friendly:
- Recyclable cardboard packaging
- Printing inks comply with
environmental standards

Lina 25 and Transcab™ cable ducting

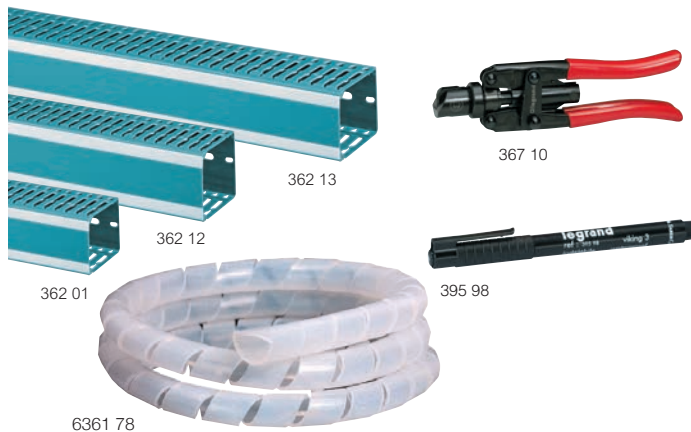

Technical characteristics (p. 177)

Transcab™ slotted duct
 Material: PVC. Colour: grey RAL 7030
 Conforms to EN 50085 Parts 2 and 3, UL and CSA
 Metric size body with finger DIN pitch 12.5 mm.
 (6 mm gap/6.5 mm finger width)
 Maximum space for cables with improved heat dissipation. Exit cables at terminal or base level. Pre-scored based enables the ducting to be snapped to length, once the reinforcement bar is removed. Reinforcement bar provides not only rigidity but also an anchor for cable ties. Rounded fingers are easily removed at the terminal or base level, without injury during wiring. Cover can be cut without surface damage due to the raised edges which also provide a guide for labels. DIN standard base fixing centres of 12.5/25 mm. Cover clips easily into position and remains firmly in place.

Technical characteristics (p. 177)

Plastic cable ducting Grey RAL 7030 (base + cover)

Pack	Cat. No.	Width x Height (mm)	Capacity (mm ²)
8	6360 95	15 x 25	264
30	6361 00	25 x 25	391
28	6361 05	40 x 25	692
20	6360 96	15 x 40	455
28	6361 01	25 x 40	720
24	6361 06	40 x 40	1245
16	6361 11	60 x 40	1932
12	6361 15	80 x 40	2647
1	6361 19	100 x 40	3363
28	6361 02	25 x 60	1159
24	6361 07	40 x 60	2007
16	6361 12	60 x 60	3115
12	6361 16	80 x 60	4200
12	6361 20	100 x 60	5307
8	6361 24	120 x 60	6403
20	6361 03	25 x 80	1600
20	6361 08	40 x 80	2717
16	6361 13	60 x 80	4216
12	6361 17	80 x 80	5716
8	6361 21	100 x 80	7215
8	6361 25	120 x 80	8729
12	6361 09	40 x 100	3354
12	6361 14	60 x 100	5216
10	6361 18	80 x 100	7078
8	6361 22	100 x 100	8960
6	6361 23	150 x 100	13683

Plastic cable ducting Grey RAL 7035 (Halogen free - base + cover)

Length per pack	Length 2 m	Width x Height (mm)	Capacity (mm ²)
30	6362 00	25 x 25	391
28	6362 01	25 x 40	720
24	6362 06	40 x 40	1245
28	6362 02	25 x 60	1159
24	6362 07	40 x 60	2700
16	6362 12	60 x 60	3115
20	6362 08	40 x 80	2717
16	6362 13	60 x 80	4216
12	6362 17	80 x 80	5716

Lina 25 ducting

RAL 2525 blue PVC, approvals CSA (Canada), UL (USA), conform to EN 50085-2-3
 Side perforations at intervals of 12.5 mm
 Length: 2 m

Length per pack	Length 2 m	Width x Height
30	362 00	25 x 25
28	362 01	25 x 40
28	362 02	25 x 60
20	362 03	25 x 80
28	362 05	40 x 25
24	362 06	40 x 40
24	362 07	40 x 60
20	362 08	40 x 80
16	362 11	60 x 40
16	362 12	60 x 60
16	362 13	60 x 80
12	362 16	80 x 60
12	362 17	80 x 80
8	362 25	120 x 80

Lina 25 cutter tool

1 367 10 For a straight break with fingers

Sleeving

Braided sleeving
 Black polyester
 Supplied in 25 m roll in dispenser box with an indicator 3 m before end

Length per pack	Length 2 m	Ø of roll	Ø variations
1	366 38	20 mm	10 to 30 mm
1	366 39	30 mm	18 to 54 mm

25 6361 78 **Spiral sleeving**
 12 mm
 395 98 **Black felt tip pen**
 Permanent marker



Accessories

25	6361 77	Spiral sleeving 6 mm
25	6361 78	Spiral sleeving 12 mm
20	366 42	22mm support for slotted cable duct
100	366 40	Din rail bracket for slotted duct
50	366 45	Label holder/cable retainer
1	366 37	Support for CAB3 markers 4 to 6 mm
10	366 36	Label holder for Cat. No. 366 37

Lina 25™ and Transcab cable ducting

■ Transcab and Lina 25: halogen free cable ducting

6.5 mm wide fingers with a 6 mm spacing
 Accepts up to 6 mm² without breaking side wall finger
 Two pre-scored lines allow removal of fingers 2 m length
 Bump on side wall fingers help cabling
 Rounded fingers prevent injury during cabling
 Conform to EN 500 85 parts 2 and 3
 Approvals:
 CSA (Canada) No 700 861 • UL (USA) No 196 692
 RAL 7030 Grey PVC / RAL 7035 PC ABS halogen free
 Plastic cable ducting (base + cover)

■ Norm EN 50085-2-3

Transcab and Lina 25 cable ducting classification

6.3 Minimum storage and transport temperature	- 5 °C
6.3 Minimum installation and application temperature	- 5 °C
6.3 Maximum application temperature	+ 60 °C
6.5 Electrical continuity characteristic	Without electrical continuity characteristic
6.6 Electrical insulating characteristic	With electrical insulating characteristic
6.9 System access	Without a tool
6.101 Mounting position	Vertical or horizontal

■ Lina 25 installation

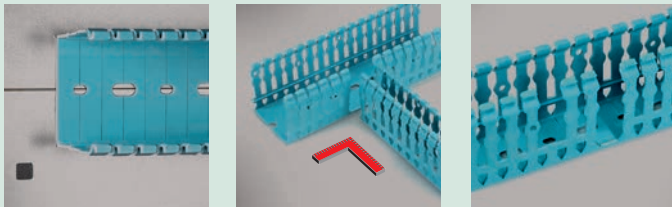

Linear positioning "T" junction Cut at two different levels for cable ducting

■ Lina 25 accessories installation

Fixing on rail

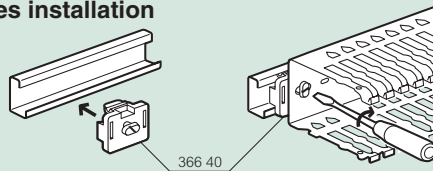

Fixing on perforated plate

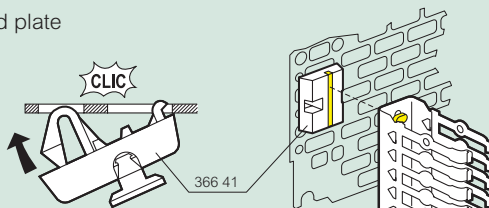

Fixing on door

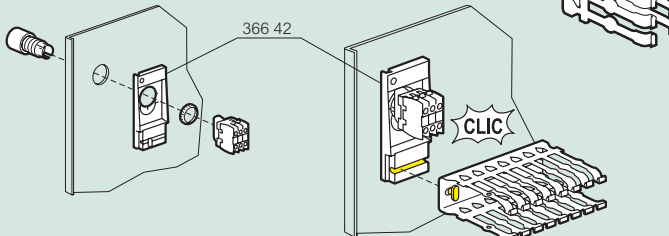

Cable retainer

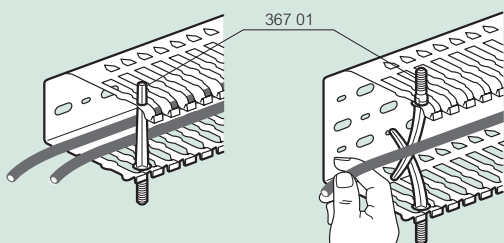

■ Dimensions

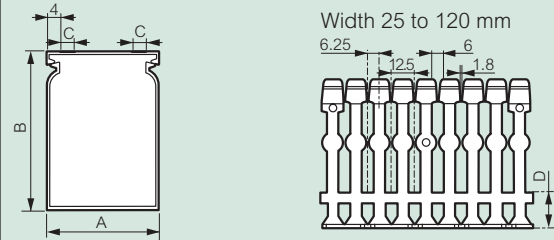

Width 80 to 120 mm

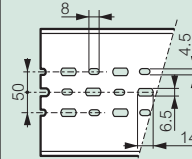

Width 25 to 60 mm

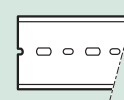

Cat.Nos	A (mm)	B (mm)	C (mm)	D (mm)
362 00 / 6361 00	25	25	6	10.1
362 01 / 6361 01	25	40	5	12.6
362 02 / 6361 02	25	60	6	16.1
362 03 / 6361 03	25	80	6	18.6
362 05 / 6361 05	40	25	10	10.1
362 06 / 6361 06	40	40	10	12.6
362 07 / 6361 07	40	60	10	16.1
362 08 / 6361 08	40	80	10	18.6
362 11 / 6361 11	60	40	10	12.6
362 12 / 6361 12	60	60	10	16.1
362 13 / 6361 13	60	80	10	18.6
362 16 / 6361 16	80	60	10	16.1
362 17 / 6361 17	80	80	10	18.6
362 25 / 6361 25	120	80	10	18.6

Calculating the ducting usable cross-section

Graph for H 05 V-K and H 07 V-K cables with 0.75 packing coefficient

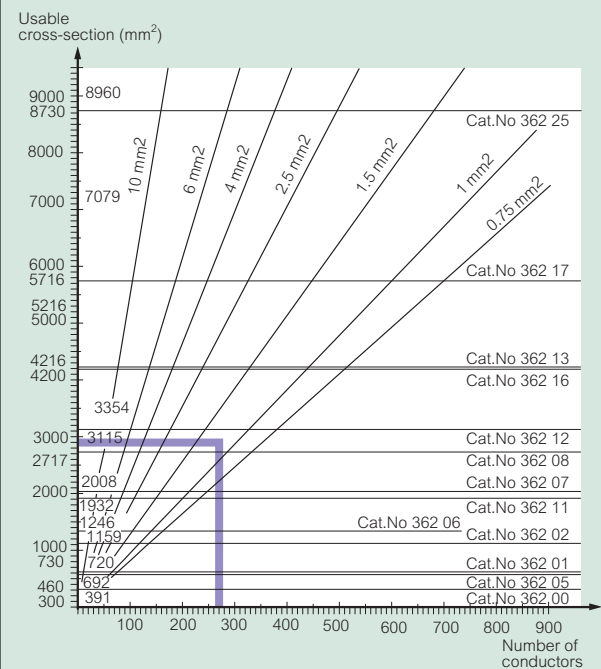

Example :

150 conductors 0.75 mm² → 1230 mm² cross-section and
 120 conductors 1.5 mm² → 1700 mm² cross-section
 Makes a total of 2930 mm²

The correct cable ducting is Cat.No 362 12, 60 x 60,
 with a capacity of 3115 mm²

Starfix™ ferrules and crimping tools



376 50



376 66



376 64



376 77



376 87



376 09 with refill Cat. No. 376 43



376 43



Cross-section adjustment



376 06



376 92

Technical characteristics (p.179)

Pack	Cat. No.	Ferrules with insulating flange			
		Provide an equipotential link for all the strands of a flexible conductor Active part in tinned electrolytic copper Conform to NF C 63-023			
		Simples in strips			
		For-cables cross-section (mm²)	Colour	Strips	Ferrules
500	376 50	0.25	turquoise	10	50
500	376 60	0.34	green	12	40
480	376 61	0.5	white	12	40
480	376 62	0.75	blue	12	40
1000	376 63	1	red	25	40
1000	376 64	1.5	black	25	40
1000	376 66	2.5	grey	25	40
250	376 67	4	orange	10	25
250	376 68	6	green	10	25
		Simples individuals (box packing)			
100	376 69	10	brown		
100	376 70	16	white		
50	376 71	25	black		
50	376 77	35	red		
30	376 78	50	blue		
		Doubles individuals			
100/500	376 87	2 x 0.75	blue		
100/500	376 88	2 x 1	red		
100/500	376 89	2 x 1.5	black		
100/500	376 90	2 x 2.5	grey		

Pack	Cat. No.	Large capacity Starfix refills		
		Large capacity for less frequent applicator reloading Translucent packaging For direct mounting on crimping tool Cat. No. 376 09		
		Cross-section (mm²)	Colour	Number of ferrules per strip
3 000	376 41	0.5	White	300
3 000	376 42	0.75	Blue	300
3 000	376 43	1	Red	300
3 000	376 44	1.5	Black	300
2 500	376 45	2.5	Grey	250
1 000	100 652	1	Red	1 000/reels
1 000	100 653	1.5	Black	1 000/reels

Pack	Cat. No.	Crimping tools for ferrules in strips
		Cut and carry out 4-point crimping of ferrules from 0.25 to 6 mm² in one operation Use recommended for spring connections Dedicated applicator for each crimping tool for dispensing strips
1	376 08	Starfix crimping tool for 0.25 and 0.34 mm² cross-sections Supplied fitted with empty applicator
1	376 09	Starfix crimping tool for 0.5 to 2.5 mm² cross-sections Fitted with an adjustment wheel Supplied fitted with empty applicator
1	376 39	Assorted kit, comprising: - 1 Starfix crimping tool, Cat. No. 376 09 fitted with empty applicator - 120 x 0.5 mm² ferrules - 120 x 0.75 mm² ferrules - 240 x 1 mm² ferrules - 320 x 1.5 mm² ferrules - 200 x 2.5 mm² ferrules
1	376 10	Starfix crimping tool for 4 and 6 mm² cross-sections Fitted with an adjustment wheel Supplied complete with empty applicator
1	376 97	Starfix S multi-purpose crimping tool for 0.5 to 2.5 mm² cross-sections Tool cuts, strips, twists, crimps Supplied complete with 5 empty applicators For left and right-handed persons

Pack	Cat. No.	Crimping tool for individual single and double ferrules
		Starfix crimping tool for 0.25 to 6 mm² cross-sections For 4-point crimping of ferrules from 0.25 to 6 mm² Use recommended for spring connections
1	376 06	Crimping tool with disengageable control system, crimping at end Right or left-handed

Pack	Cat. No.	Starfix clamp for 10 to 50 mm² cross-section
1	376 92	Assorted kit: supplied comprising: - 1 tool with crimping operation control system for individual ferrules 10 to 50 mm² - 30 individual ferrules 10 mm² - 20 individual ferrules 16 mm² - 15 individual ferrules 25 mm² - 10 individual ferrules 35 mm² - 10 individual ferrules 50 mm²

Some items sold separately

For pack quantity, please refer to numerical index pages

For trade price, please see your local HPM Legrand representative for the current price list

Starfix™ applicator

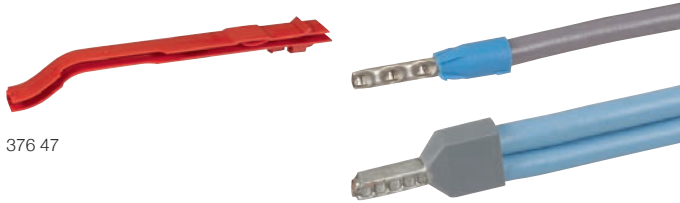

376 47

Example of simple/double ferrules on wires

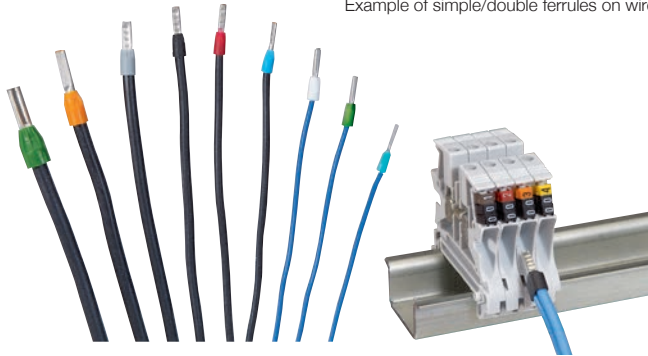

Example of different wires and ferrules

Pack	Cat. No.	Starfix applicator	For Starfix crimping tool	For ferrules cross-section (mm²)	Colour
10	376 46		For dispensing strips of ferrules in Starfix crimping tools Cat. No. 376 08/09/10	0.25 and 0.34	yellow
10	376 47			0.5 to 2.5	red
10	376 48			4 and 6	orange

Starfix™ applicator

Correspondence table

Cross-section (mm²)	Simple ferrule	Large capacity ferrule - refills	Starfix applicator
0.5	376 61	376 41	376 47
0.75	376 62	376 42	376 47
1	376 63	376 43	376 47
1.5	376 64	376 44	376 47
2.5	376 66	376 45	376 47

Dimensions (mm)

Simple ferrules

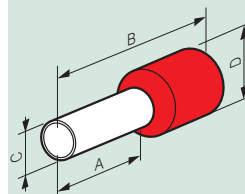

Cat. No.	Cross-section (mm²)	A	B	C	D
376 50	0.25	8	14.5	1.1	3
376 60	0.34	8	14.5	1.1	3
376 61	0.5	8	14.5	1.5	3.4
376 62	0.75	8	14.5	1.5	3.4
376 63	1	8	14.5	1.7	3.6
376 64	1.5	8	14.5	2	4.1
376 66	2.5	8	14.5	2.6	4.8
376 67	4	12	21	3.2	5.7
376 68	6	12	23	3.9	7.2
376 69	10	12	21	4.9	8.1
376 70	16	18	29	6.3	9.8
376 71	25	18	31	7.9	12
376 77	35	18	32	8.9	13.5
376 78	50	20	36	11.1	16.1

Double ferrules

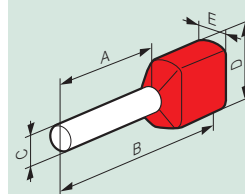

Cat. No.	Cross-section (mm²)	A	B	C	D	E
376 87	2 x 0.75	8	15	2.1	6	3.3
376 88	2 x 1	8	15	2.35	6	4
376 89	2 x 1.5	8	16	2.6	7.2	4.2
376 90	2 x 2.5	10	18.5	3.3	8.4	4.8

Example of use Starfix tool



1. Fit the applicator



2. Adjust



The 2-material handle gives an excellent grip



3. Insert the wire



4. Crimp

Starfix S tool



1. Adjust the cross-section

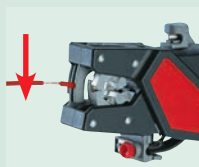

2. Strip and twist

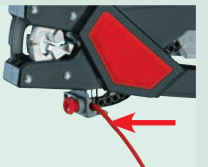

3. Crimp

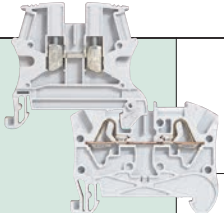

Viking 3: Screw or spring connection terminal blocks and common accessories

see p. 162-167

CAB 3™ marking system

Markers for wiring and Viking 3 terminal blocks



Perfect alignment of label holders



382 12

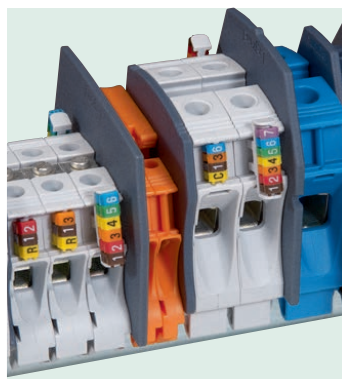

Terminal block with CAB 3 markers and label-holders

Pack	Cat. No.	Markers for wiring 0.15 to 0.5 mm ² and 0.5 to 1.5 mm ² cross-section and terminal blocks	
		On Viking 3 terminal blocks	
		- 4 markers 0.15 to 0.5 mm ² max.	
		- 3 markers 0.15 to 1.5 mm ² max.	
		Pack:	
		- Up to 0.5 mm ² : strips of 25 markers	
		- From 0.5 mm ² to 2.5 mm ² : strips of 30 markers	
		- Upper 2.5 mm ² : strips of 20 markers	
		Price per marker	
		Digits: international colour code	
		0 Black	
		1 Brown	
		2 Red	
		3 Orange	
		4 Yellow	
		5 Green	
		6 Blue	
		7 Purple	
		8 Grey	
		9 White	
		Letters: black on yellow background	
		A	
		B	
		C	
		D	
		E	
		F	
		G	
		H	
		I	
		J	
		K	
		L	
		M	
		N	
		O	
		P	
		Q	
		R	
		S	
		T	
		U	
		V	
		W	
		X	
		Y	
		Z	
		Conventional symbols: black on yellow background	
		/	
		•	
		+	
		-	
		~	
		=	
		±	

Pack	Cat. No.	Markers for wiring 1.5 to 2.5 mm ² and 4 to 6 mm ² cross-section	
		Pack:	
		- Up to 0.5 mm ² : strips of 25 markers	
		- From 0.5 mm ² to 2.5 mm ² : strips of 30 markers	
		- Upper 2.5 mm ² : strips of 20 markers	
		Price per marker	
		Digits: international colour code	
		0 Black	
		1 Brown	
		2 Red	
		3 Orange	
		4 Yellow	
		5 Green	
		6 Blue	
		7 Purple	
		8 Grey	
		9 White	
		Letters: black on yellow background	
		A	
		B	
		C	
		D	
		E	
		F	
		G	
		H	
		I	
		J	
		K	
		L	
		M	
		N	
		O	
		P	
		Q	
		R	
		S	
		T	
		U	
		V	
		W	
		X	
		Y	
		Z	
		Conventional symbols: black on yellow background	
		/	
		•	
		+	
		-	
		~	
		=	
		±	

CAB 3™ marking system

Accessories



384 90



384 92



383 92 with markers
CAB 3



382 00



383 97



StarFix Ferrules see (p. 178)

Pack Cat. No. Accessories CAB 3

Marker-holders

For cables cross-section from 10 mm² to 70 mm²
Capacity:
8 digits, letters or symbols markers from 0.5 to 1.5 mm² or 1.5 to 2.5 mm² cross section
Black, cross-section (mm²)

100	384 90	10 to 16
50	384 91	25 to 35
50	384 92	50 to 70

Support for markers

Can be clipped on Viking 3 terminal blocks

Capacity:
7 markers from 0.15 to 0.5 mm²
6 markers from 0.5 to 1.5 mm²

Transparent applicators

For rapid selection and application of markers onto cable

For markers cross-section (mm ²)	Applicator colour for identification of cross-section
0.15 to 0.5	CAB 3
0.5 to 1.5	CAB 3
1.5 to 2.5	CAB 3
4 to 6	CAB 3

Set of markers

1	382 01	0.15 to 0.5 mm ² : 2 500 markers + 10 applicators (250 digits from 0 to 9)
1	382 02	0.5 to 1.5 mm ² : 3 000 markers + 10 applicators (300 digits from 0 to 9)
1	382 03	1.5 to 2.5 mm ² : 3 000 markers + 10 applicators (300 digits from 0 to 9)
1	382 04	4 to 6 mm ² : 2 000 markers + 10 applicators (200 digits from 0 to 9)

On-site toolbox

1	382 00	With removable tray for CAB 3 markers and applicators, Starfix ferrules... Height 85 mm, depth 280 mm, width 450 mm Metal, padlockable
---	--------	--

CAB 3™ marking system

For wiring and Viking 3 terminal blocks

Dimensions

Markers

Polyamide 6/6

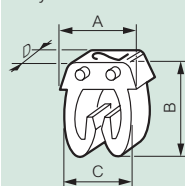

Dimensions	Cable cross-section (mm ²)			
	0.15 to 0.5	0.5 to 1.5	1.5 to 2.5	4 to 6
A (mm)	5	5	5.6	8
B (mm)	5.05	6.4	7.6	9.6
C (mm)	3.7	4.3	4.9	7.1
D (mm)	2.3	3	3	3
Ø mini/maxi (mm)	0.8/2.2	2.2/3	2.8/3.8	4.3/5.3

Cat. No. 381 50 to 381 55 et 381 60 to 381 65: no liking stud.
D = 6 mm

Marker holders

Cat.No 384 90

Cat.No 384 91

Cat.No 384 92

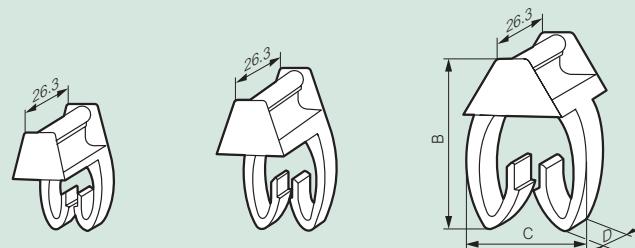

Dim.	Section of cable for marking (mm ²)		
	10 to 16	25 to 35	50 to 70
A (mm)	18	24.3	27.2
B (mm)	8.9	12.2	17.2
C (mm)	7	7	10

Support for markers Cat.No 383 92

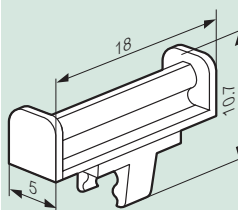

On cable with marker-holder Cat.No 384 92



Characteristics and dimensions of on-site toolbox

Cat.No 382 00

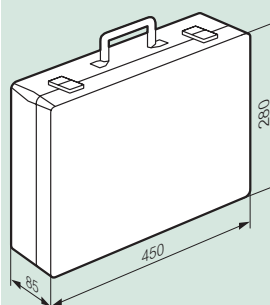

Bottom tray consists of:

- 8 medium slots (each slot takes 1 box of CAB 3)
- 1 large slot

Top tray consists of:

- 12 small slots (<=> approx. 6 boxes of CAB 3)
 - 1 medium slot for applicators
- Capacity: approx. 15000 CAB 3 markers

On terminal blocks with support
Cat.No 383 92



On power terminal blocks

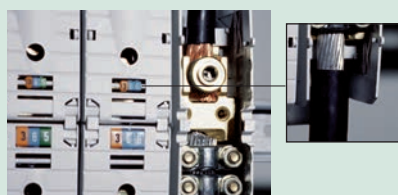

Memocab™ marking system

For wiring



Marking system with closed ring
High resistance in very aggressive environments

Pack	Cat. No.	Marker-holders for wiring			
		Section (mm ²)		Ø (mm)	
		min.	max.	min.	max.
Length of marking: 15 mm (6 markers)					
1000	379 30	0.25	1.5	1.3	3.5
1000	379 31	0.75	4	2.3	4.8
500	379 32	4	16	4.2	7.6
Length of marking: 18 mm (7 markers)					
1000	379 36	0.25	1.5	1.3	3.5
1000	379 37	0.75	4	2.3	4.8
500	379 38	4	16	4.2	7.6
500	379 33	16	50	7.6	12.5
200	379 34	50	95	12.5	19
100	379 35	95	300	19	29.5
Length of marking: 30 mm (12 markers)					
500	379 40	0.25	1.5	1.3	3.5
500	379 41	0.75	4	2.3	4.8
200	379 42	4	16	4.2	7.6
200	379 43	16	50	7.6	12.5
Length 500 mm (to be cut)					
10	379 44	0.75	4	2.3	4

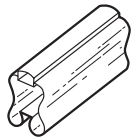
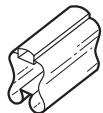
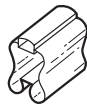

Marker-holders for simultaneous marking of both ends

Pre-cut label holders in rolls

Length of marking: 18 mm (7 markers)

Pack	Cat. No.	Section (mm ²)		Ø (mm)	
		min.	max.	min.	max.
1000	379 20	0.25	1.5	1.3	3.5
1000	379 21	0.75	4	2.3	4.8
500	379 22	4	16	4.2	7.6
500	379 10	0.25	1.5	1.3	3.5
500	379 11	0.75	4	2.3	4.8

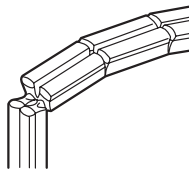

Marker-holders for cables

Fixing with Colring cable ties

100 377 12 Length of marking: 20 mm (8 markers or 1 marker Logicab 2 Cat.No 385 05)

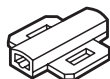

Marker-holders for all devices

Length of marking: 17.5 mm (7 markers)

100 377 10 Adhesive

Accessories

Pack	Cat. No.	Description
1	379 91	Double dispenser board For 48 strips of markers (supplied empty)
		Selecting prong For selecting the markers and placing them in the label holder
10	379 90	For 30 mm marker holders
10	379 92	For 15 mm marker holders
10	379 89	Double for 30 or 18 mm marker holders (for simultaneous marking of both ends)
		Extractor
10	379 93	For 15 mm marker holders



Marking kit to use on site

Pack	Cat. No.	Description
1	379 99	Composition <ul style="list-style-type: none"> • 1 dispenser board Cat.No 379 91 • 2 selecting prongs Cat. No. 379 90/92 • 1 extractor Cat.No 379 93 • 50 label holders (0.25 - 1.5mm) • 50 label holders (0.75 - 4mm) • 20 label holders (4 - 16mm)
1	379 94	Composition Same as 379 99 plus: complete with markers 0 to 9, A to Z and symbols <ul style="list-style-type: none"> • 1 selecting prong Cat.No 379 89 • 4 strips 0 - 9 (96) • 1 strip A - Z (24) • 1 strip symbols (24) Cat. No. 379 94 also referred to as Cat. No. 379 999 previous to 2006



Memocab™ marking system

For wiring (continued)



378 01 to 378 10



378 05 + 2 x 378 06 + 378 01 +
378 10 + 378 09 + 378 08
in a label holder Cat.No 379 38

Pack	Cat. No.	Markers
Numbers on colour background		
Black or white marking (international colour code)		
600	378 01	Purple 7
600	378 02	Orange 3
600	378 03	White 9
600	378 04	Grey 8
600	378 05	Green 5
600	378 06	Yellow 4
600	378 07	Brown 1
600	378 08	Blue 6
600	378 09	Black 0
600	378 10	Red 2



378 06

Pack	Cat. No.	Markers
Numbers on white background		
Black marking		
600	377 80	0
600	377 81	1
600	377 82	2
600	377 83	3
600	377 84	4
600	377 85	5
600	377 86	6
600	377 87	7
600	377 88	8
600	377 89	9



377 85

Pack	Cat. No.	Markers
Capital letters		
Black marking on white background		
240	378 26	A
240	378 27	B
240	378 28	C
240	378 29	D
240	378 30	E
240	378 31	F
240	378 32	G
240	378 33	H
240	378 34	I
240	378 35	J
240	378 36	K
240	378 37	L
240	378 38	M
240	378 39	N
240	378 40	O
240	378 41	P
240	378 42	Q
240	378 43	R
240	378 44	S
240	378 45	T
240	378 46	U
240	378 47	V
240	378 48	W
240	378 49	X
240	378 50	Y
240	378 51	Z



378 30

Pack	Cat. No.	Markers
Conventional symbols		
Black marking on white background		
240	379 54	/
240	379 55	•
240	379 56	+
240	379 57	-
240	379 58	~
240	379 59	≡
240	379 60	±



379 56

Memocab™ marking system

For wiring

Installation



1. Simultaneous marking of both ends

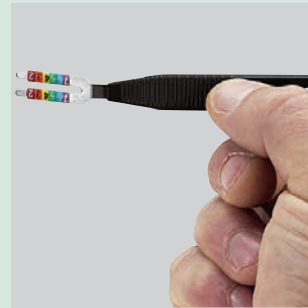

2. Use of double selecting prong



3. Installation in double marker-holder

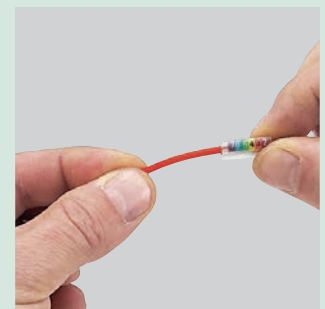

The double strip can be used on site, where each marker-holders of both side will be placed on conductors

Duplix™ marking system

For cables



Cat. No. 384 52 with label and label-holder Cat. No. 384 98



Cat.No 384 56 with marker and protective cover Cat.No 384 97



Opened marking system with marker-holders Cat.No 384 55

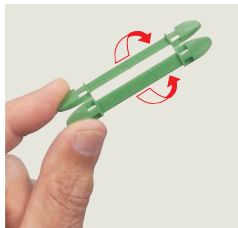

Clip-on marking system

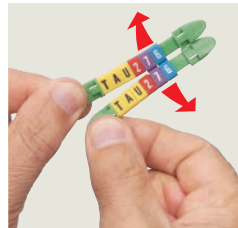
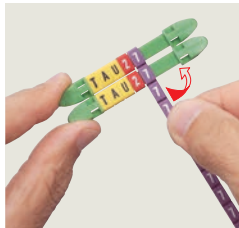
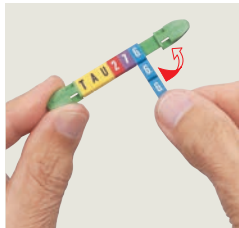

Opened or closed marking system, with markers or labels

Pack	Cat. No.		Marker-holders
	7 markers	14 markers	Fitted using Colring 2.4 and 3.5 mm cable ties
100	384 50	384 60	● Black
100	384 52	384 62	● Red
100	384 54	384 64	● Yellow
100	384 55	384 65	● Green
100	384 56	384 66	● Blue

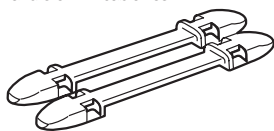

		Markers
		Price per marker
		Numbers:
		Black or white marking on colour background (international colour code)
		Supplied by packs of 40 x 20 markers
800	384 00	0 Black
800	384 01	1 Brown
800	384 02	2 Red
800	384 03	3 Orange
800	384 04	4 Yellow
800	384 05	5 Green
800	384 06	6 Blue
800	384 07	7 Purple
800	384 08	8 Grey
800	384 09	9 White



600	384 10	A
600	384 11	B
600	384 12	C
600	384 13	D
600	384 14	E
600	384 15	F
600	384 16	G
600	384 17	H
600	384 18	I
600	384 19	J
600	384 20	K
600	384 21	L
600	384 22	M
600	384 23	N
600	384 24	O
600	384 25	P
600	384 26	Q
600	384 27	R
600	384 28	S
600	384 29	T
600	384 30	U
600	384 31	V
600	384 32	W
600	384 33	X
600	384 34	Y
600	384 35	Z

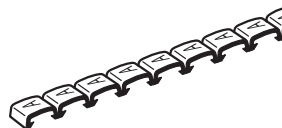

Pack	Cat. No.	Markers (continued)
		Conventional symbols:
		Black on a yellow background
600	384 40	/
600	384 41	•
600	384 42	+
600	384 43	-
600	384 44	~
600	384 45	≡
600	384 46	≡
600	384 99	Blank
		Set of Duplix markers
1	384 96	100 pieces of each number from 0 to 9

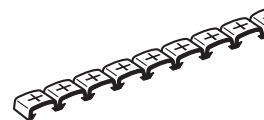

		Accessories
		Label-holder for 7 markers
100	384 98	Clips onto marker-holders Duplix or on end cap Cat. No. 375 13
		UV protective cover
100	384 97	Enables closed cable marking system Clips onto label-holders for 7 markers

On-site toolbox (p. 181)