

Data Sheet



LED Satellite Surface Mount – D63



CAT NO. 659015LI, 659016LI



659015LI

Cat. No.	659015LI	659016LI
Colour	White	Black
Battery pack	Li-ion 6.4 V, 3.0 Ah	
Operating Voltage	230 - 240 V a.c. 50 Hz	
Power Consumption	2 W	
Body Constructions	Polycarbonate	
Operating Temperature	10° to 40°	
IP Rating	IP20	
Compliance	AS/NZS 2293, AS/NZS 60598, AS/NZS 4268, AS CISPR 15	
Product Marking	  R-NZ	



GALAXY
CONNECTED EMERGENCY LIGHTING SYSTEM



LED Satellite Surface Mount – D63



CAT. NO. 659015LI, 659016LI

- Embedded Bluetooth for smart device connectivity.
- Low Power Wide Area Network type of communications utilising the LoRa platform.
- LoRa communication to maximise reliability, coverage and infiltration.
- iSmart™ temperature sensing technology for the Li-ion battery.
- Electronics designed to lengthen the life of the battery, minimising maintenance costs.
- Environmentally friendly battery
- Easy to install.
- One high Brightness LED.
- 5 Year Warranty.
- Designed and manufactured in Australia.

Cat. No.	Description	Classification C ₀ /C ₉₀
659015LI	Galaxy LED Satellite Surface Mount White	D63
659016LI	Galaxy LED Satellite Surface Mount Black	D63

DIMENSIONS

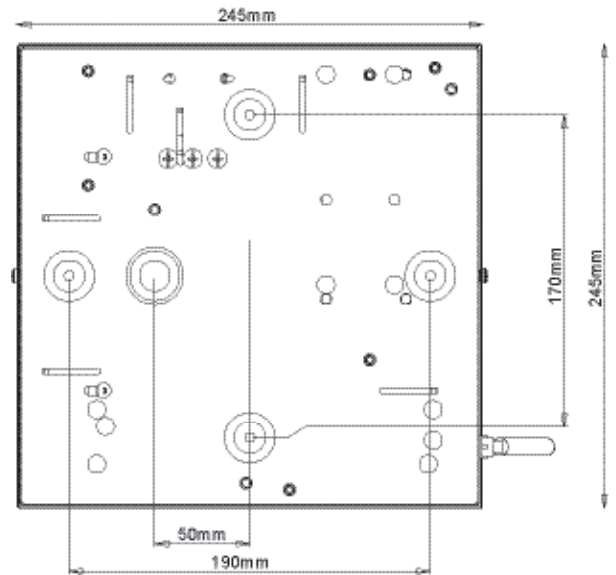

Spacing table:

Maximum spacings between luminaires for 0.2 lux (Australia)

Mounting Height (m)	2.4	2.7	3	3.3	3.6	4.0
A	20.3	21.1	21.8	22.4	23.0	23.7
B	20.3	21.1	21.8	22.4	23.0	23.7

Maximum spacings between luminaires for 1 lux (New Zealand)

Mounting Height (m)	2.4	2.7	3	3.3	3.6	4.0
A	11.4	11.8	12.1	12.3	12.5	12.7
B	11.4	11.8	12.1	12.3	12.5	12.7

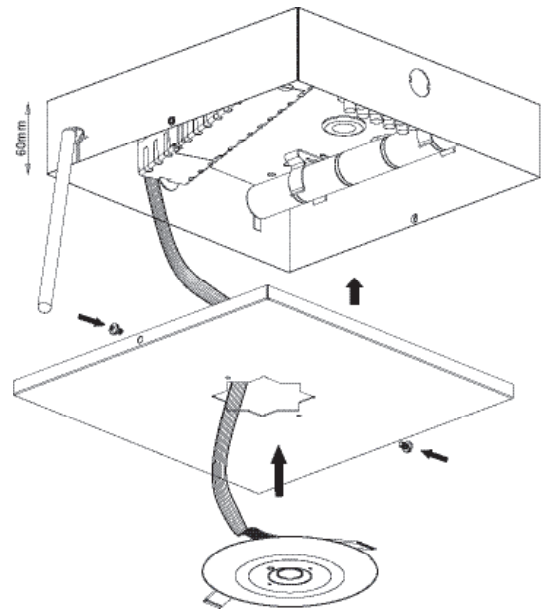
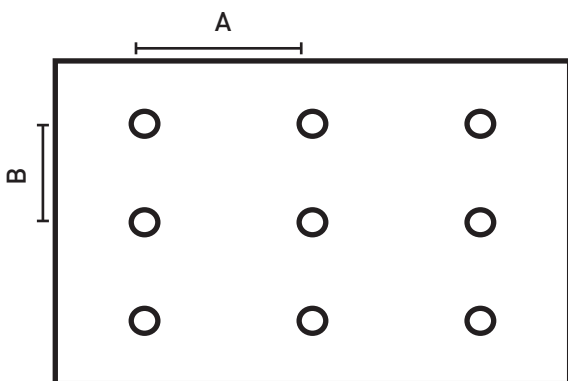

Legrand - Australia
1300 369 777
www.legrand.com.au
ABN 31 000 102 661

Legrand - New Zealand
0800 476 009
www.legrand.co.nz

Refer to your group buying office, Legrand Sales Representative or Legrand Sales Office for pricing.

Please note: specifications are subject to change without prior notice.

